

M A C A O



Air Post

Newspaper



MALAYA

Tiger

Watermarked Crown and "C A"

1901



Watermarked Multiple Crown and "C A"

1904-10



MALAYA

Tiger

Watermarked Multiple Crown and "C A"

1906-22



Watermarked Multiple Crown and Script "C A"

1922-32



MALAYA

Tiger

Watermarked Multiple Crown and Script "C A"

1922-32



Chalky Paper



Elephants and Howdah

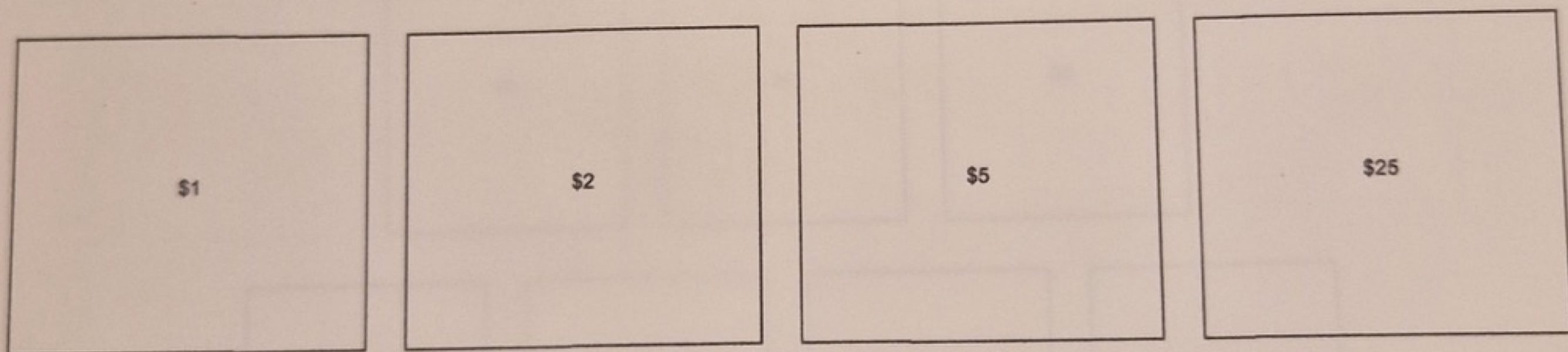

Tiger

1931-34

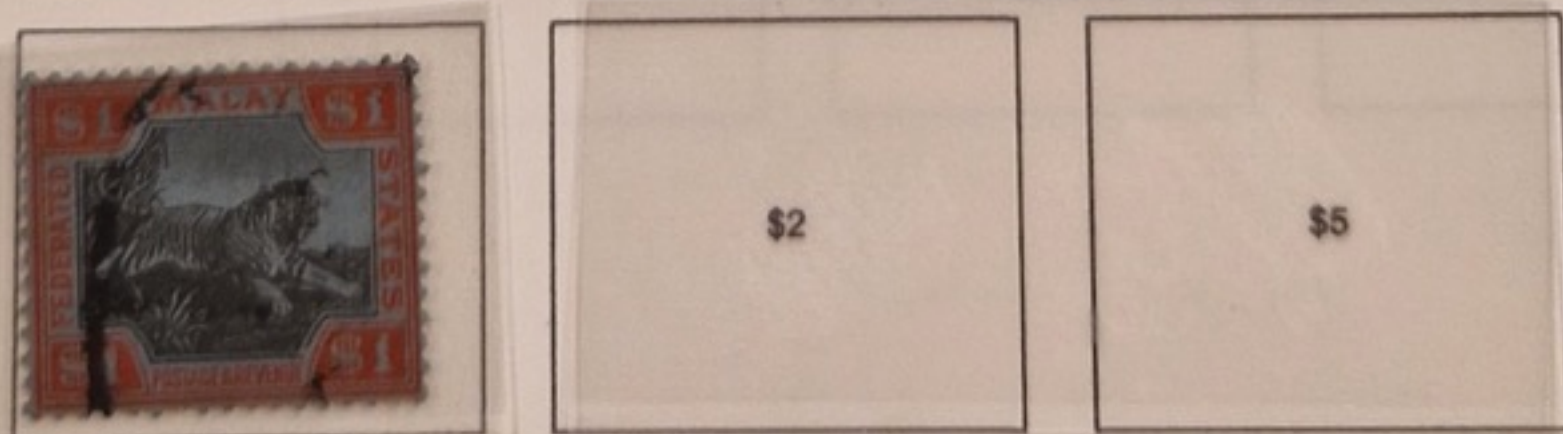

MALAYA

JOHORE



KEDAH



MALAYA

KELANTAN



MALACCA



NEGRI SEMBILAN



MALAYA

PAHANG



PENANG



PERAK



PERLIS



MALAYA

SELANGOR



Japanese Occupation



SUNGEI UJONG



TRENGGANU



Semi-Postal



MALAYA

FEDERATED MALAY STATES



FEDERATION OF MALAYA



Japanese Occupation



MALAYA

Thai Occupation



MALAYA

Johore

1893-94

Like cut
1 C
LILAC
AND VIOLET



3 C
LILAC AND
CARMINE
ROSE

1894



1896

2 C
LILAC AND
YELLOW



3 C
LILAC AND
CARMINE
ROSE

1896-98



2 C
GREEN
AND BLUE

3 C
GREEN
AND VIOLET

4 C
GREEN AND
CARMINE
ROSE

5 C
GREEN
AND BROWN

1903

Types of 1896-98
Surcharged

3 CENTS.

On 4 C
YELLOW
AND RED

10 C
On 4 C
GREEN AND
CARMINE
ROSE

1899

Type of 1896-98
4 C
YELLOW
AND RED



2 C
VIOLET AND
ORANGE

1904-18

4 C
VIOLET
AND RED



8 C
VIOLET
AND BLUE



10 C
VIOLET
AND BLACK

1919-24



4 C
VIOLET
AND RED



10 C
VIOLET
AND BLUE

1922-24

Same
6 C
VIOLET AND
RED BROWN

10 C
VIOLET
AND YELLOW

12 C
VIOLET
AND BLUE

1924-26

Same
2 C
VIOLET
AND BROWN

3 C
GREEN

1928

Same
2 C
GREEN AND
DARK GREEN

3 C
DULL VIOLET
AND BROWN

21 C
DULL VIOLET
AND ORANGE

1935



1940



STRAITS SETTLEMENTS

Johore

1940

Type of
1904-18
12 C
ULTRA-
MARINE

1948-49

10 C
PURPLE

Types of Turks and
Caicos Is.
Inscribed
"Malaya Johore"
\$ 5
GREEN



2 C
ORANGE

3 C
GREEN



8 C
ROSE RED



15 C
ULTRA-
MARINE

20 C
DARK GREEN
AND BLACK



40 C
DARK VIOLET
AND
ROSE RED



\$ 1
VIOLET
BROWN AND
ULTRA-
MARINE

\$ 2
ROSE RED
AND
EMERALD

\$ 5
CHOCOLATE
AND
EMERALD

MALAYA

Kedah

1912



3 C
CARMINE
AND BLACK

4 C
SLATE AND
CARMINE

5 C
ORANGE
BROWN
AND GREEN

8 C
ULTRAMARINE
AND BLACK



1921-36

Same
1 C
BROWN

1 C
BLACK

2 C
GREEN

3 C
DARK VIOLET

3 C
GREEN

4 C
CARMINE



6 C
SCARLET

10 C
BLACK BROWN
AND BLUE

12 C
DARK ULTRAMARINE
AND BLACK

8 C
GRAY

1937

Like cut
10 C
SEPIA AND
ULTRAMARINE



25 C
BROWN VIOLET
AND
ULTRAMARINE

30 C
DEEP CARMINE
AND
YELLOW GREEN

40 C
BROWN VIOLET
AND BLACK



STRAITS SETTLEMENTS

Malacca

1948-49



Types of Turks
and Caicos Is.
Inscribed
"Malaya Malacca"

\$ 5

LIGHT BROWN

Type of
Singapore
Inscribed
"Malacca"

1 C

BLACK



3 C

GREEN

4 C

CHOCOLATE

6 C

GRAY

8 C

ROSE RED



MALAYA

Negri Sembilan

1891



1892

Like cut
1 C
GREEN



1895-1900



1899

Regular Issues
Surcharged

Four cents

On 5 C
BLUE

1935-36

Like next cut
1 C
BLACK



6 C
ROSE RED

8 C
GRAY

10 C
DARK VIOLET

12 C
ULTRAMARINE

STRAITS SETTLEMENTS

Negri Sembilan

1941

Type of 1935 36 2 C BROWN ORANGE	3 C GREEN	6 C GRAY	15 C ULTRA- MARINE
---	--------------	-------------	--------------------------

1948-49

10 C PURPLE	Types of Turks and Caicos Is. Inscribed "Malaya Negri Sembilan" \$ 5 GREEN
----------------	--

		3 C GREEN			8 C ROSE RED	
---	---	--------------	---	---	-----------------	---

	15 C ULTRA- MARINE	20 C DARK GREEN AND BLACK		40 C DARK VIOLET AND ROSE RED	50 C ULTRA- MARINE AND BLACK	
---	--------------------------	------------------------------------	---	---	---------------------------------------	---

MALAYA

Pahang

1892-95

Like next cut
1 C
GREEN



1896-99

4 C
LILAC AND
CARMINE
ROSE



5 C
LILAC
AND OLIVE

1935-36



2 C
DEEP GREEN



8 C
GRAY

10 C
DARK VIOLET

12 C
ULTRAMARINE

25 C
ROSE RED
AND
PALE VIOLET

STRAITS SETTLEMENTS

Penang

1948

10 C
PURPLE

Types of Turks and
Caicos Is.
Inscribed
"Malaya Penang"

\$ 5
LIGHT
BROWN

1949



3 C
GREEN

40 C
DARK VIOLET
AND
ROSE RED



\$ 1
VIOLET
BROWN AND
ULTRA-
MARINE

\$ 2
ROSE RED
AND
EMERALD

\$ 5
CHOCOLATE
AND
EMERALD

MALAYA

Perak

1895

1886-90



5 C
BLUE

Types of 1892
2 C
ORANGE



1895-96



1 C
On 5 C
LILAC
AND OLIVE

3 C
On 8 C
LILAC
AND BLUE

1900

1935-36



6 C
ROSE RED

8 C
GRAY



12 C
ULTRAMARINE

25 C
ROSE RED
AND
PALE VIOLET

1938-40



6 C
ROSE RED



10 C
DARK VIOLET

12 C
ULTRAMARINE

25 C
ROSE RED
AND
PALE VIOLET

30 C
ORANGE AND
DARK VIOLET



50 C
BLACK ON
EMERALD

STRAITS SETTLEMENTS

Perak

1941

Type of 1938-39 2 C BROWN ORANGE	3 C GREEN	8 C ROSE RED	15 C ULTRA- MARINE
---	--------------	-----------------	--------------------------

1948

10 C PURPLE	Types of Turks and Caicos Is. Inscribed "Malaya Perak" \$5 GREEN
----------------	---



STRAITS SETTLEMENTS

Perlis

1948

10 C
PURPLE

Types of
Turks and Caicos Is.
Inscribed
"Malaya Perlis"
\$5
LIGHT BROWN



MALAYA

Selangor

1892-95

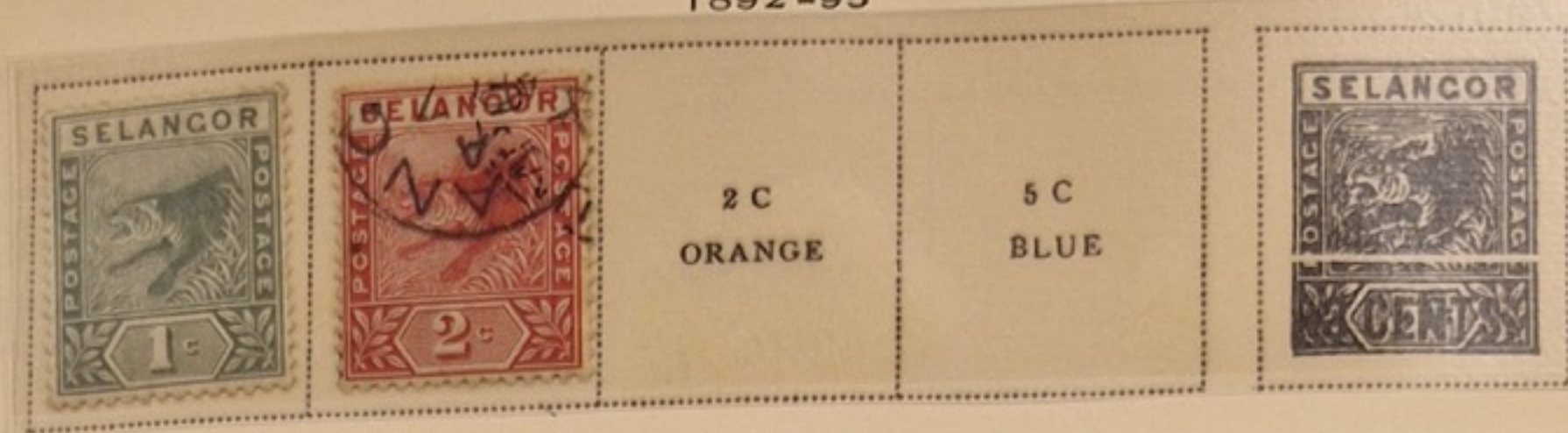

1895-99

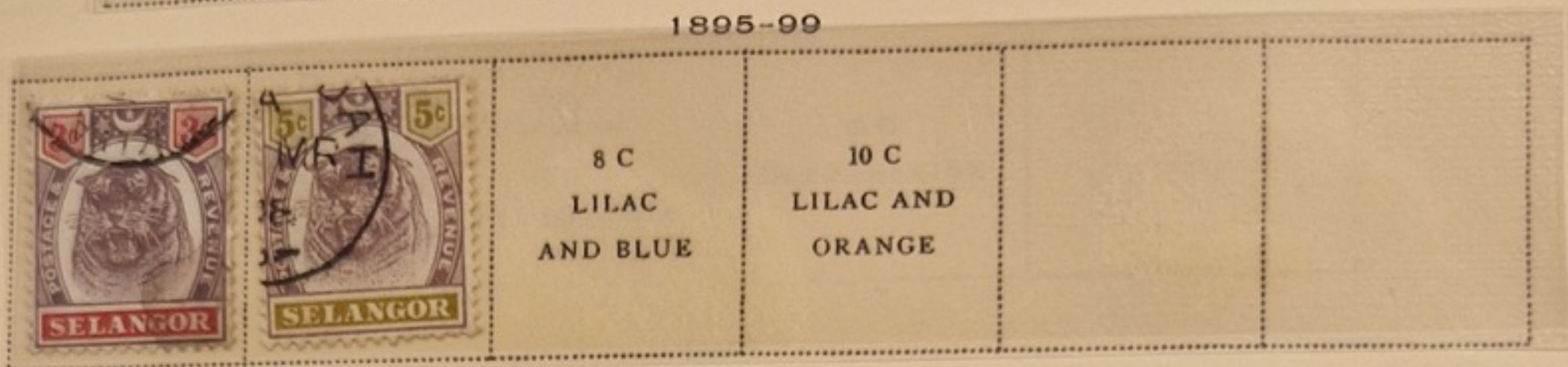

1935-36



STRAITS SETTLEMENTS

Selangor

Issued under Japanese Occupation

1942

	Stamps of 1935-41 Handstamped 3 C GREEN	5 C CHOCOLATE		
--	--	------------------	--	--

MALAYA 2602 DAI NIPPON	Same Overprinted 12 C ULTRAMARINE	15 C ULTRAMARINE		
------------------------------	--	---------------------	--	--

1943

大日本郵便 1 C BLACK	Same Overprinted 3 C GREEN	12 C ULTRAMARINE	大日本郵便 1 C BLACK	5 C CHOCOLATE
-----------------------	-------------------------------------	---------------------	-----------------------	------------------

Surcharged Like next cut 2 C On 5 C CHOCOLATE	3 C On 5 C CHOCOLATE		大日本郵便 6 cts. On 5 C CHOCOLATE	
---	----------------------------	--	--	--



STRAITS SETTLEMENTS

Trengganu

1948

10 C
PURPLE

Types of
Turks and Caicos Is.
Inscribed
"Malaya Trengganu"

\$5
ROSE
CARMINE



MALDIVE ISLANDS

1909



1933



MALTA

Queen Victoria
Unwatermarked
1860-61



Watermarked Crown and C. C.
1863-78

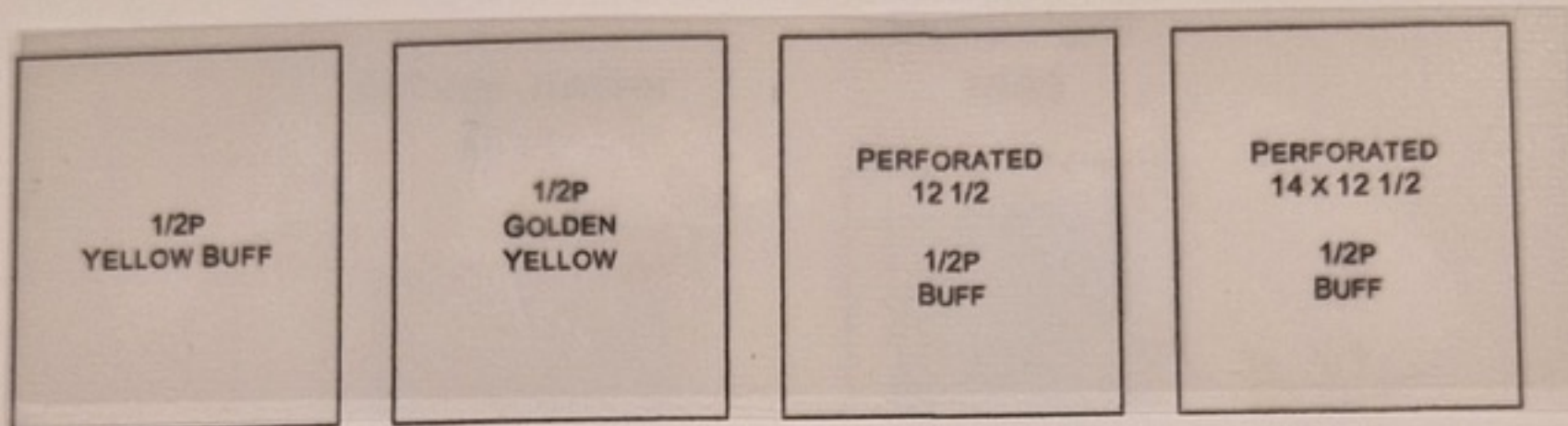

Watermarked Crown and C. A.
1882



1885



MALTA

Gozo Fishing Boat,
Ancient Galley
1899



"Malta", St. Paul After Shipwreck
1899

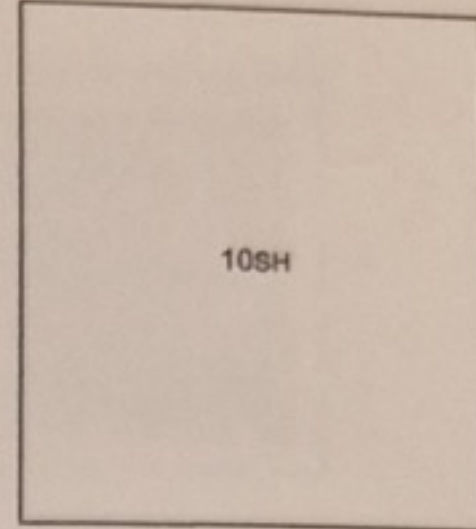
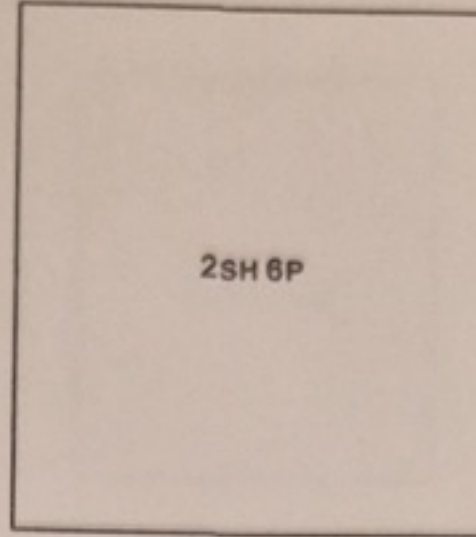

Valletta Harbor
1901



1885 Stamp
Surcharged
1902



King Edward VII
Watermarked Crown and C. A.
1903-04

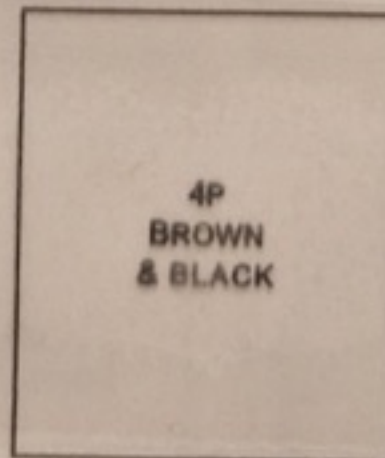
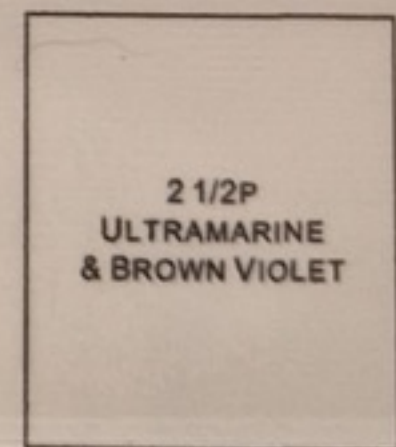

MALTA

King Edward VII
Watermarked Multiple Crown and C. A.
1904-11



1P
CARMINE



2 1/2P
ULTRAMARINE

4P
BROWN &
BLACK



1SH
BLACK ON
GREENISH

5SH
SCARLET &
GREEN ON
YELLOWISH

Valletta Harbor, Gozo Fishing Boat, and Ancient Galley
Watermarked Multiple Crown and C. A.
1904-11



5P
RED



4 1/2P
BLACK BROWN



MALTA

King George V

Watermarked Multiple Crown and C. A.

1914-21



2 1/2P

MALTA

King George V, St. Paul
Watermarked Multiple Crown and Script C. A.
1921-22

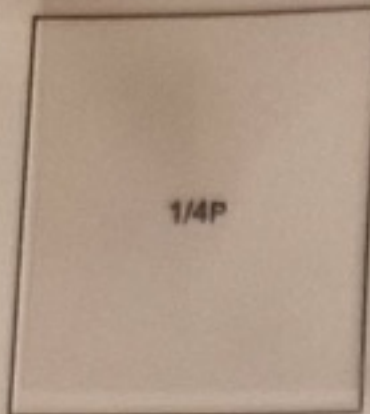

1/4P

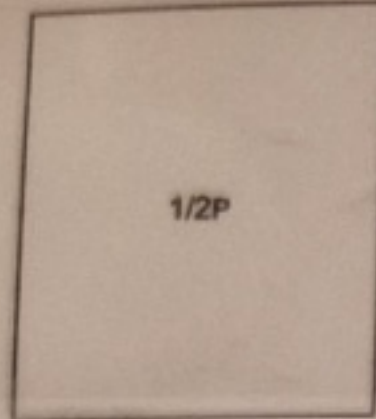

1/2P

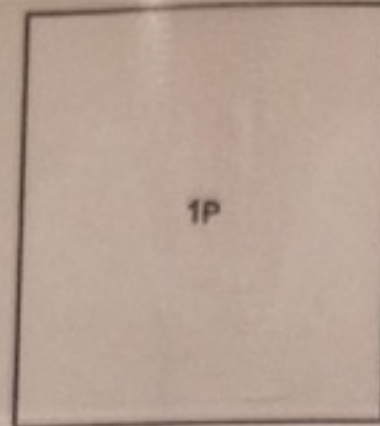

1P

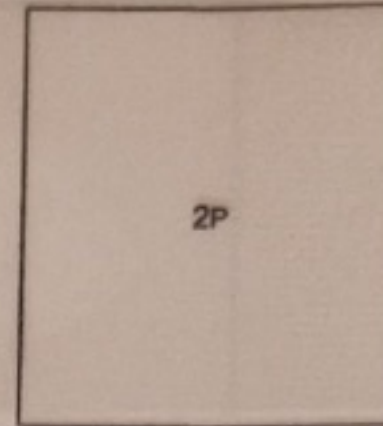

2P

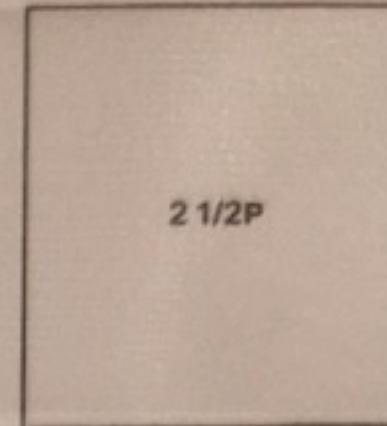

2 1/2P



6P

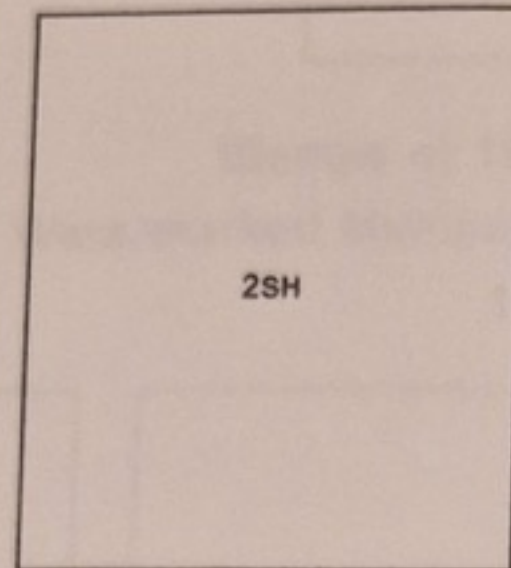

2SH

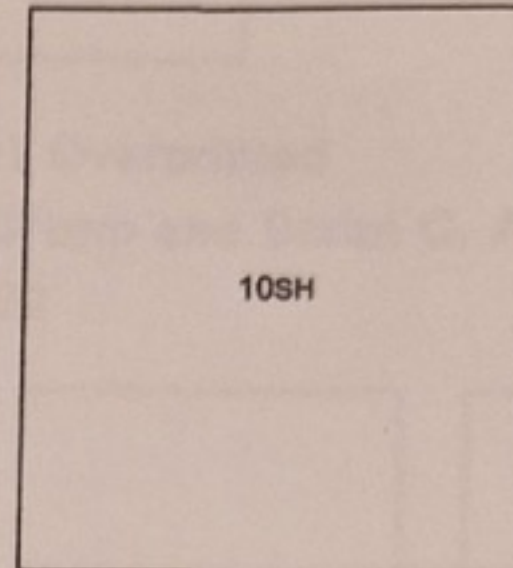

10SH

Stamps of 1914-19 Overprinted in Red or Black
Watermarked Multiple Crown and C. A.
1922

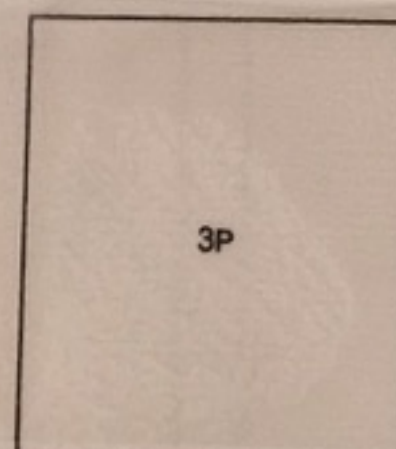

3P

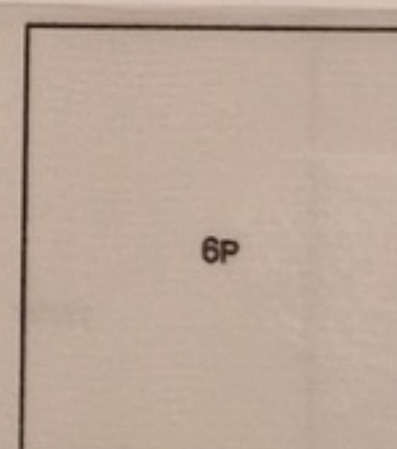

6P

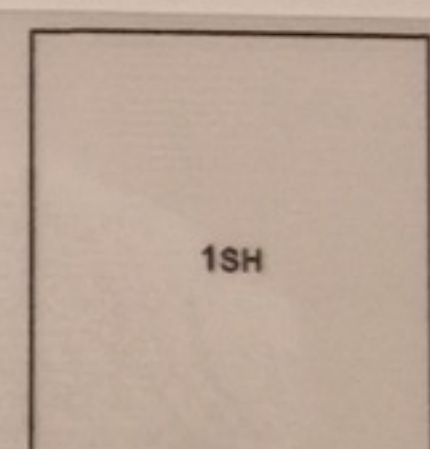

1SH

MALTA

Stamp of 1899 Overprinted
Watermarked Crown and C. C.
1922

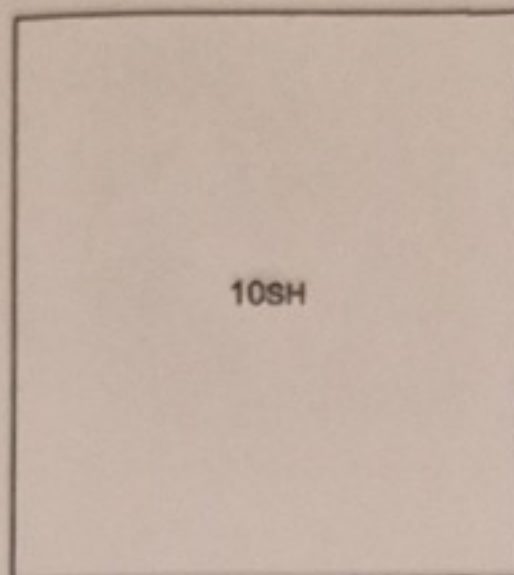

Stamps of 1921 Overprinted
Watermarked Multiple Crown and Script C. A.
1922

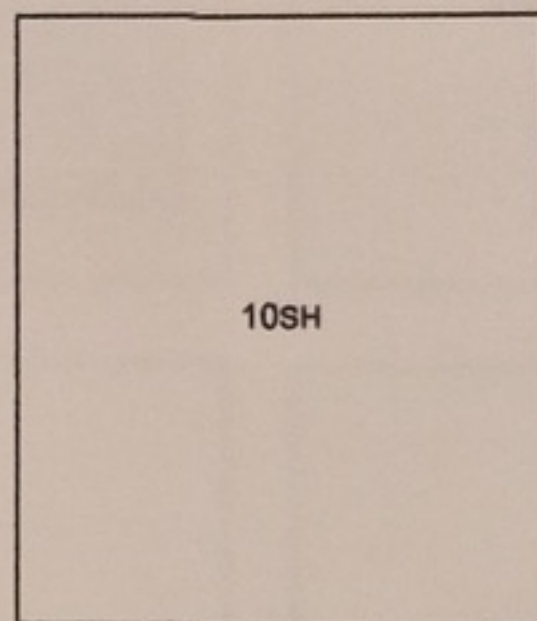
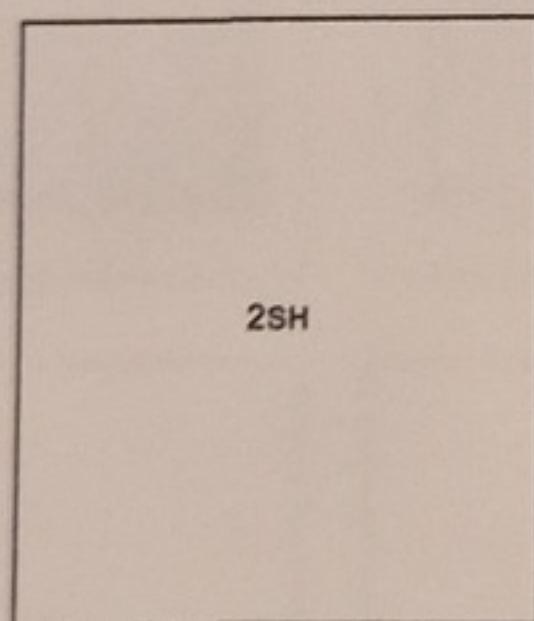
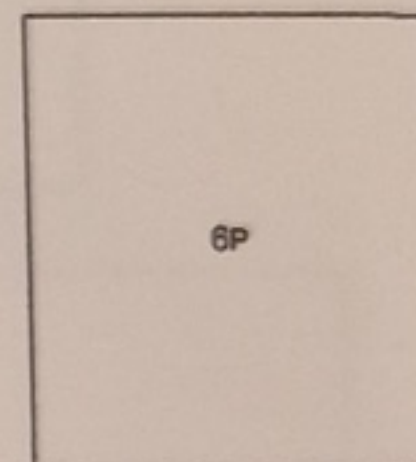
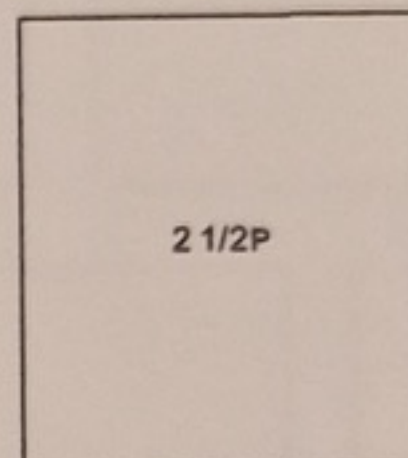
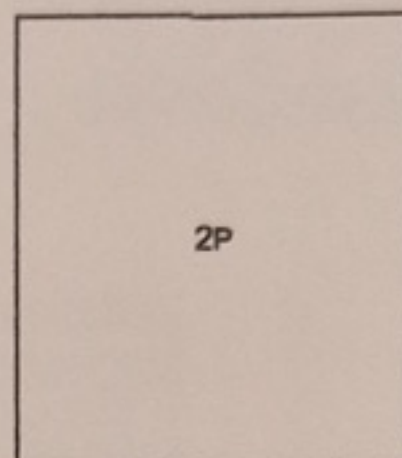
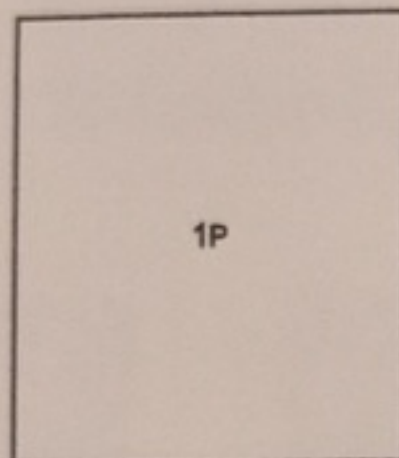
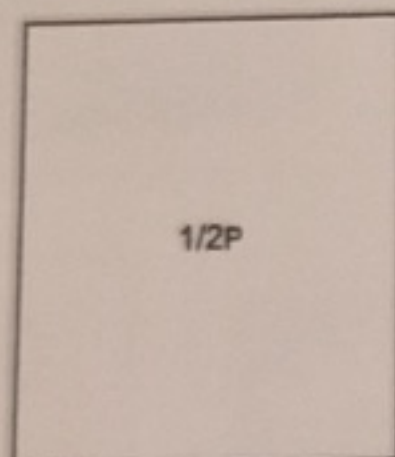
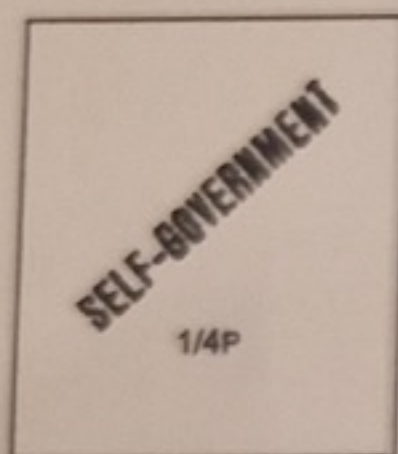

Stamp of 1921 Surcharged
1922



MALTA

"Malta", Britannia and Malta
1922-26



3P
BLACK ON
YELLOWISH



2SH

2SH 6P

MALTA

Stamp of 1922 Surcharged
1925

Two pence
halfpenny

ON 3P
ULTRAMARINE

Stamps of 1922-26 Overprinted
1926

POSTAGE

1/4P



1P
VIOLET



2P

2 1/2P



MALTA

King George V and Pictorials

Inscribed: "Postage"

1926-27



MALTA

Stamps and Type of 1926-27 Overprinted in black
1928

POSTAGE
AND
REVENUE
1/4P



1P
ORANGE BROWN

1 1/2P
YELLOW BROWN

1 1/2P
RED

2P



3P

MALTA

King George V and Pictorials
Inscribed: "Postage & Revenue"
1930

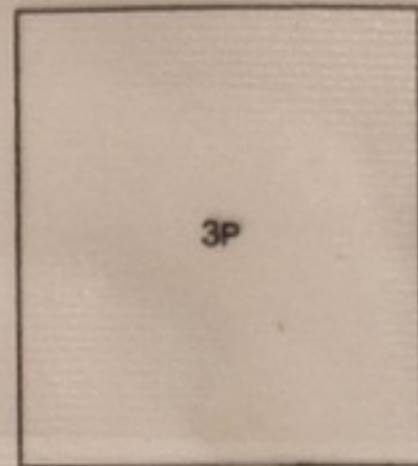
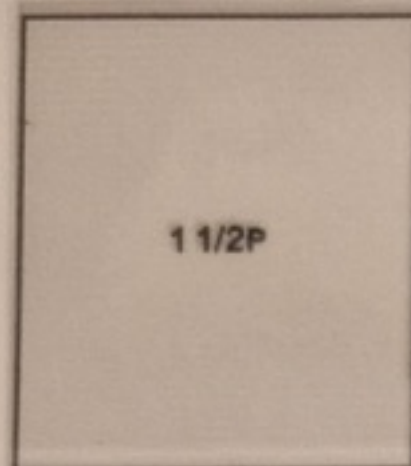
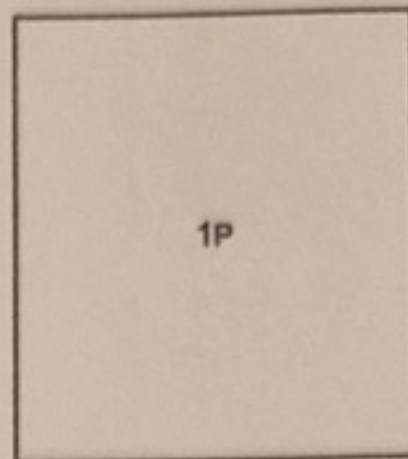
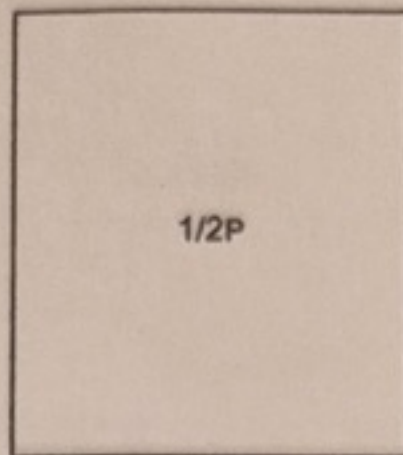
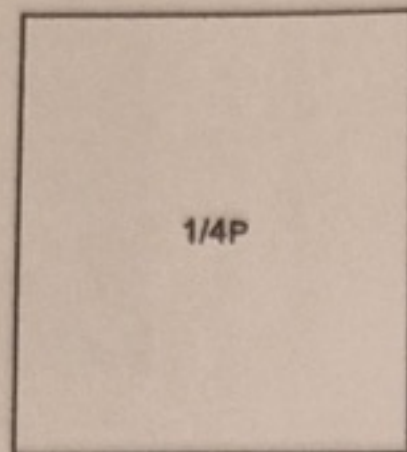

MALTA

Silver Jubilee
1935



2 1/2P

6P

15H

Coronation
1937

1/2P

1 1/2P

2 1/2P

MALTA

King George VI Pictorials

1938

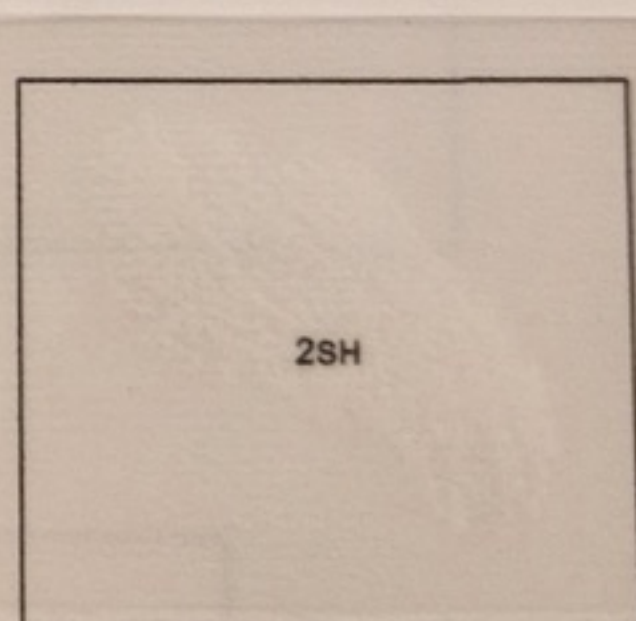
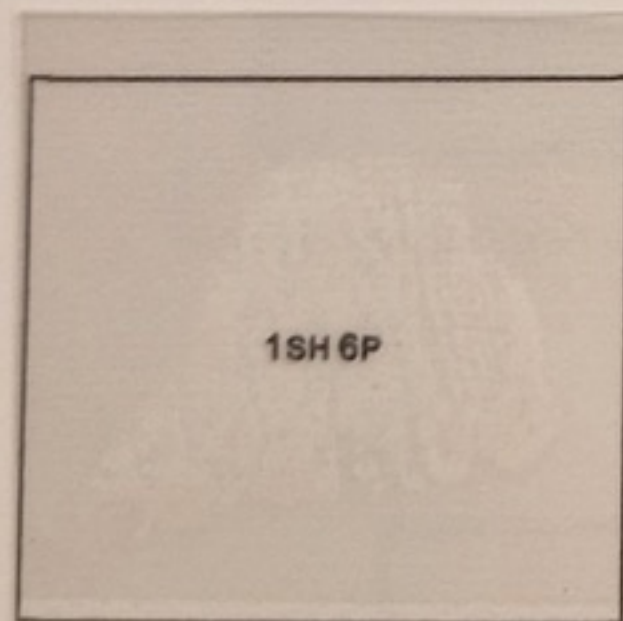
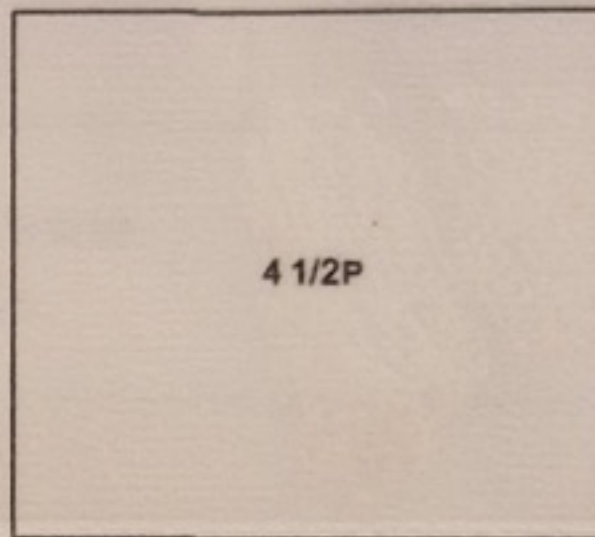
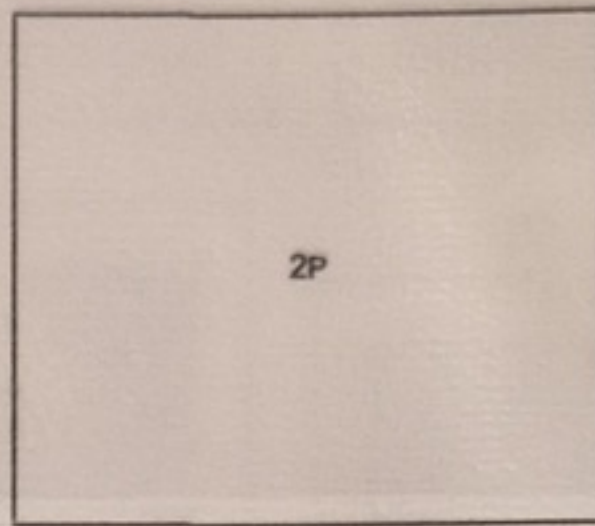

MALTA

King George VI Pictorials 1943



Peace Issue 1946

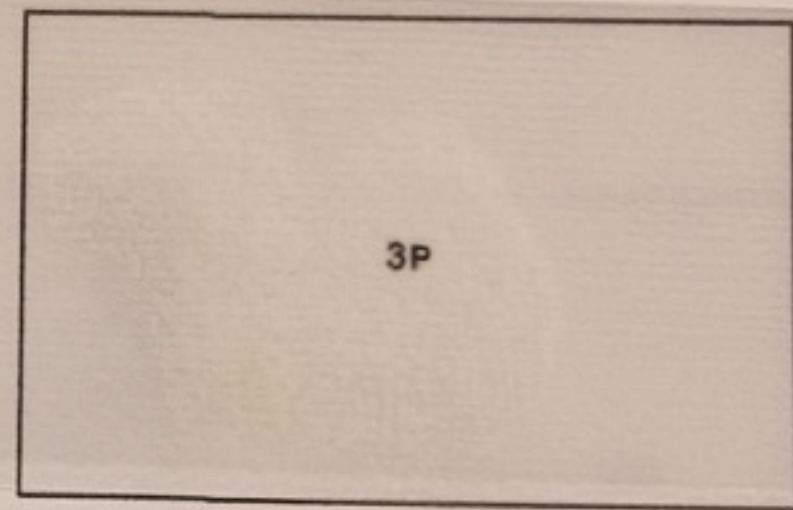

MALTA

Stamps of 1938-43 Overprinted
1948

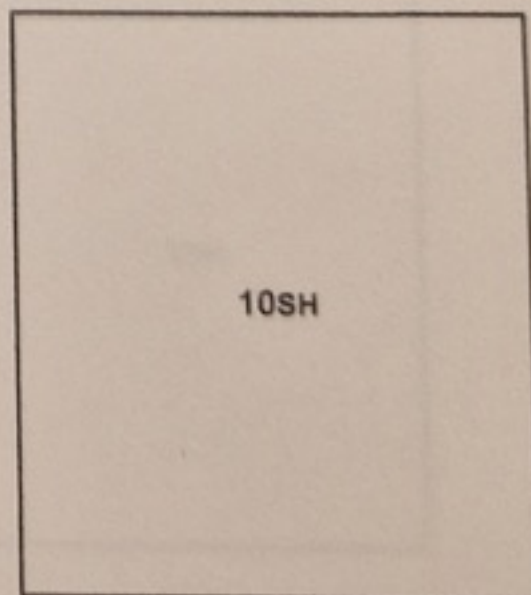
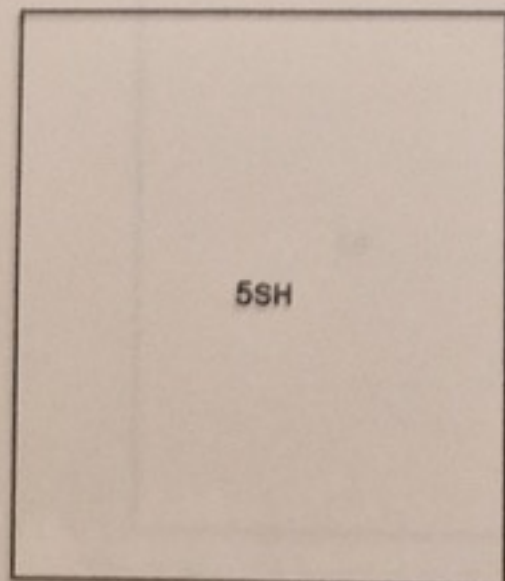
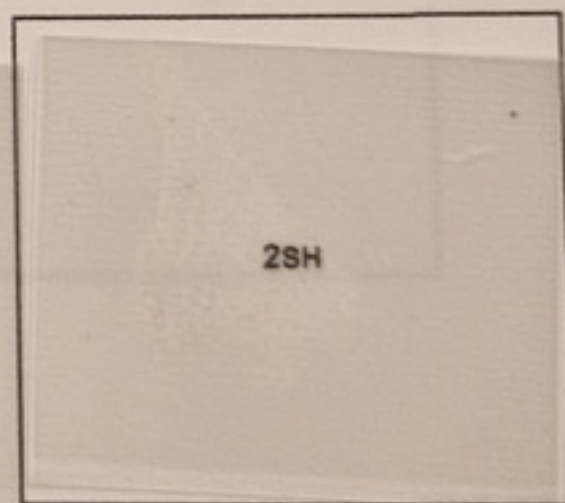

MALTA

Types of 1938-43 Overprinted
1953

1P

2P

2 1/2P



MANCHUKUO

1932



2 F
SLATE



6 F
ROSE

7 F
GRAY

8 F
OCHRE



16 F
TURQUOISE
GREEN



30 F
ORANGE

1933



Like 2 F
10 F
DEEP BLUE

1934



Like 1 1/2 F
6 F
GREEN

Like 3 F
10 F
DARK BLUE

1934-36



1 1/2 F
DARK VIOLET

3 F
BROWN

5 F
DARK BLUE

6 F
ROSE

7 F
DARK GRAY



18 F
PRUSSIAN
GREEN



1935



1936-37



1/4 F
VIOLET



5 F
GRAY BLACK



1937-38



Like 2 F
10 F
DARK GREEN

Like 4 F
20 F
DARK BLUE

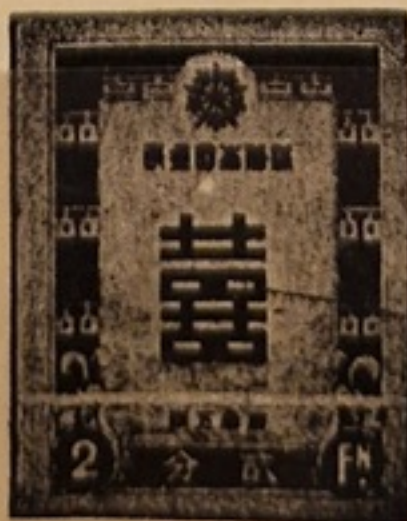

ALBUM PAGE

MANCHUKUO

1941-45



6 F
CRIMSON
ROSE

10 F
LIGHT
BLUE

20 F
BROWN



MANCHUKUO

Map and Other Designs 1937

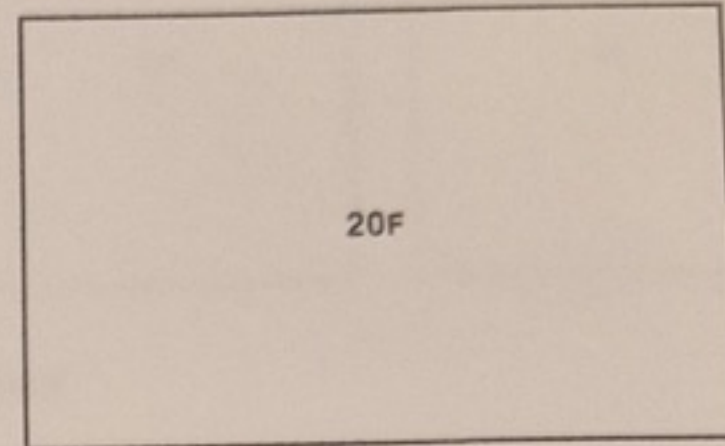
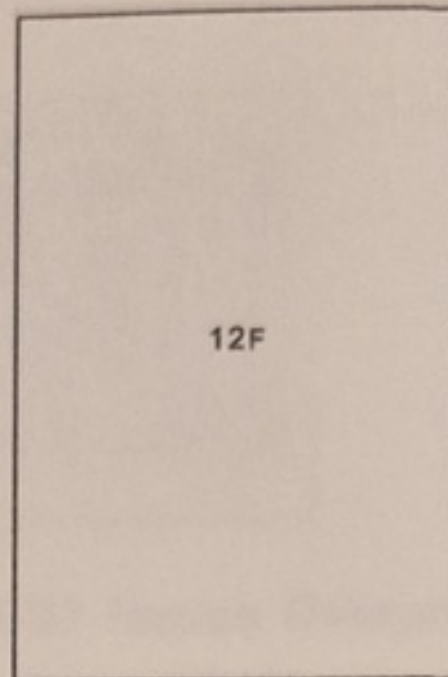
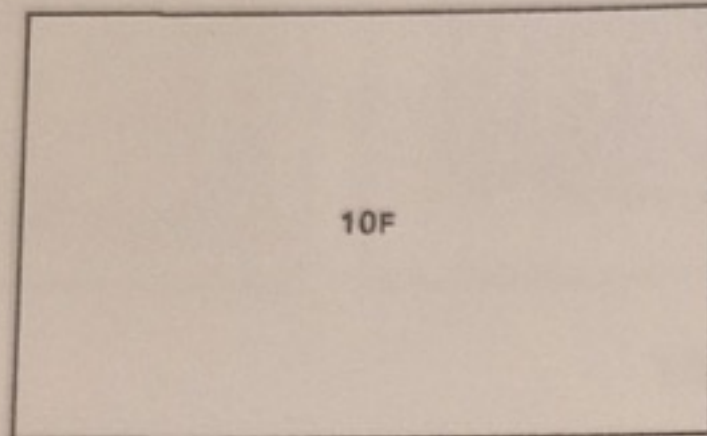
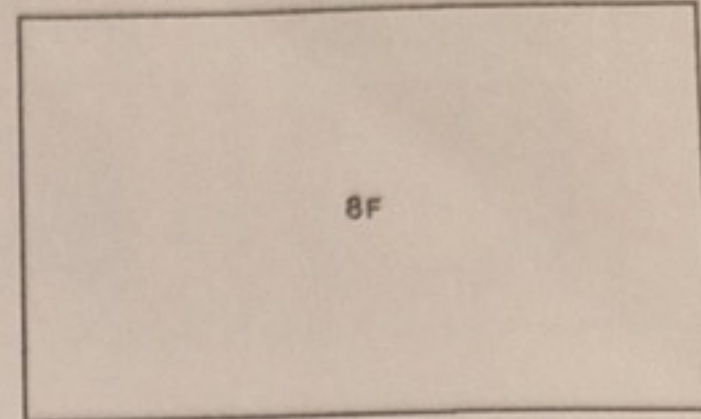
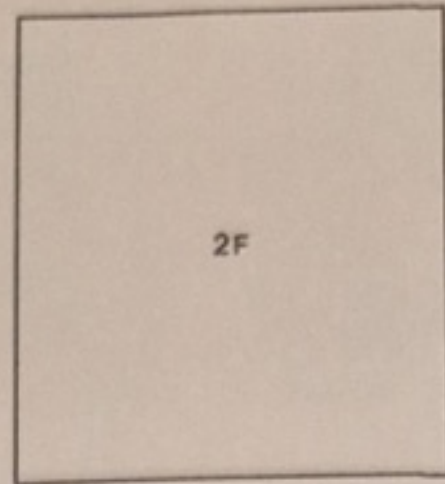
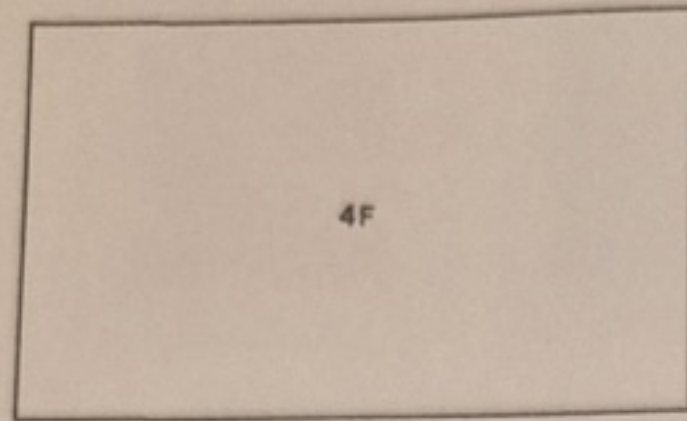

New Year Greetings 1937

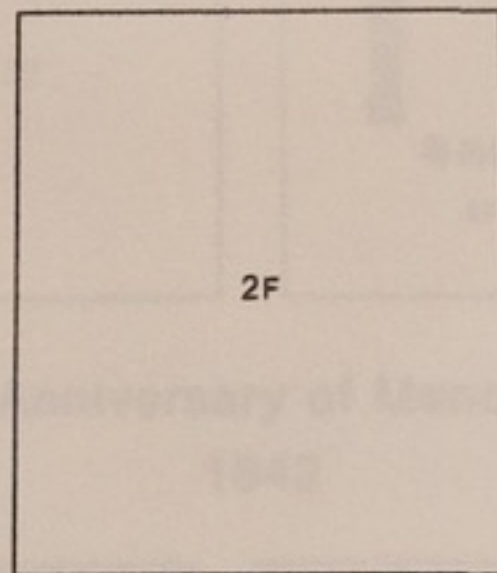

Map and Cross 1938

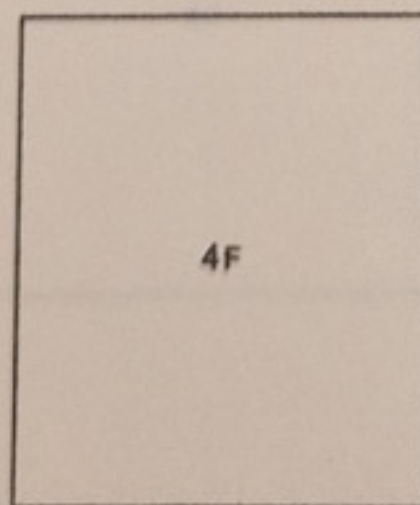
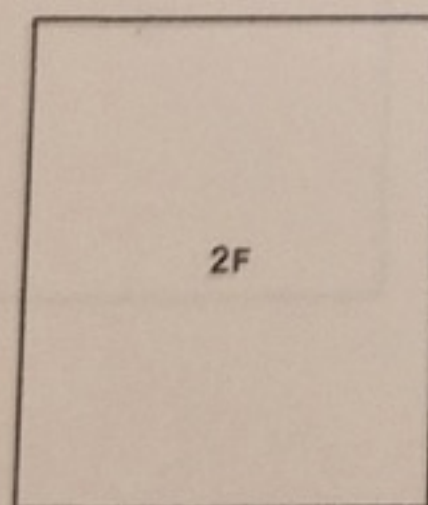

Network of Railroads, Train 1939



MANCHUKUO

Stork Above Flagship
1940



Census Taker and Map
1940



Message, Dragon Dance
1940



Soldier
1941

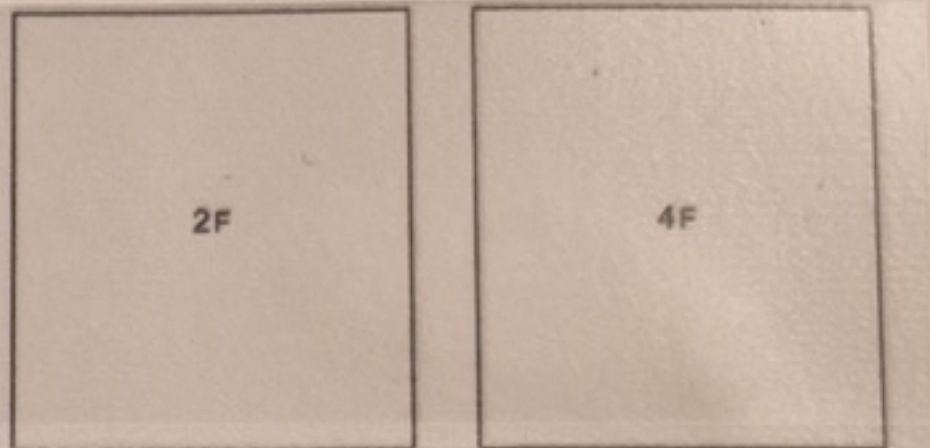

MANCHUKUO

AIR POST STAMPS

Plane Over Sheep Grazing, Plane Over Railroad Bridge
1936-37

18F

19F



39F

MARIENWERDER

1920



15 P
GRAY



P
R:



20 P
BROWN
ORANGE



MESOPOTAMIA



Official



MONACO



MONACO



MONACO

PRINCIPAUTÉ DE L'EUROPE OCCIDENTALE

Population : 15,200 habitants. — Superficie : 22 kmc.

Prince : ALBERT, Honoré-Charles, né le 13 novembre 1848, a succédé à son père le 10 septembre 1889.



Chef-lieu : Monaco, 3,300 habitants.

Ville principale : Monte Carlo.

UNITÉ MONÉTAIRE : 1 franc = 100 centimes.

La principauté de Monaco se trouve enclavée dans le département des Alpes-Maritimes, ancien Comté de Nice, au sud-est de la France. Lorsque, en 1856, mourut le prince Florestan I^{er}, la couronne revint à son fils Charles-Honoré Grimaldi, né le 8 décembre 1818, qui régna sous le nom de Charles III. Après la cession du Comté de Nice à la France (1860) par le roi de Sardaigne, Charles III accepta volontairement le protectorat français et consentit, moyennant une compensation pécuniaire à céder à la France une partie de son territoire dont les habitants avaient opté pour la nationalité française (2 février 1861).

1885. — Effigie à droite de Charles III.



1 c. vert-bronze. 2 c. violet. 5 c. bleu. 10 c. brun s. jaune. 15 c. rose. 25 c. vert. 40 c. bleu s. rose.



1 c. olive. 2 c. violet. 5 c. bleu. 10 c. brun s. jaune. 15 c. rose. 25 c. vert. 40 c. bleu s. rose.

1901. — Id.



5 c. vert-jaune. 10 c. carmin. 15 c. brun-jaune. 25 c. bleu.

MONACO

1891-1922

1885

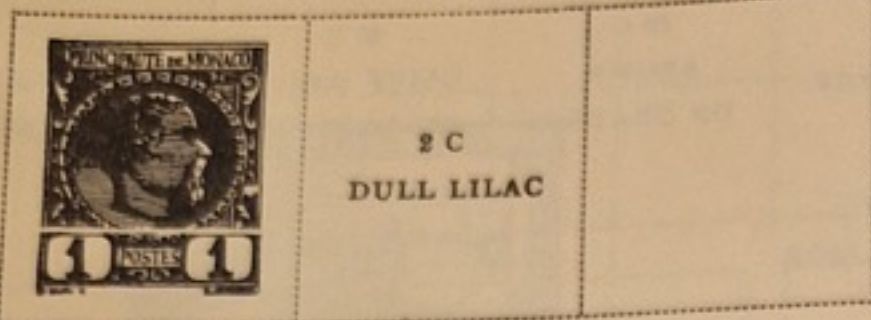

2 C
DULL LILAC



5 C
BLUE



5 C
YELLOW
GREEN

1891-1922

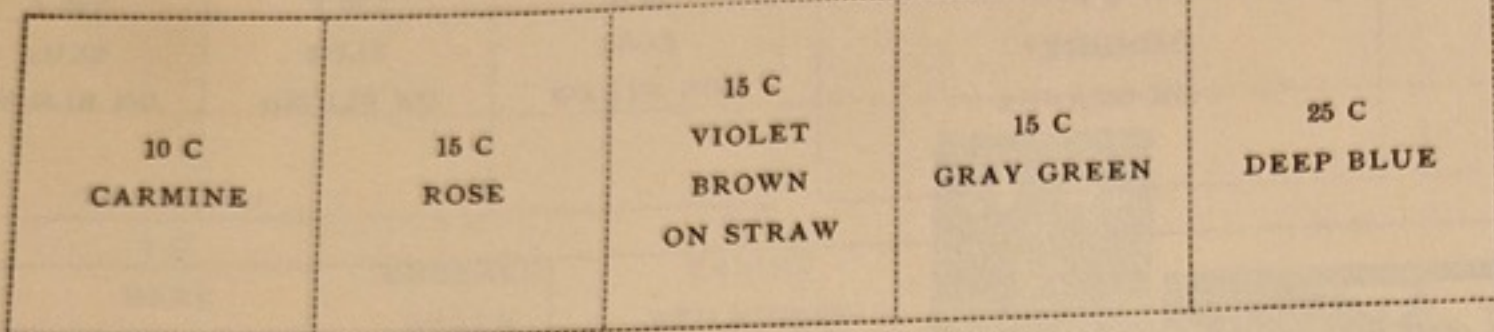

10 C
CARMINE

15 C
ROSE

15 C
VIOLET
BROWN
ON STRAW

15 C
GRAY GREEN

25 C
DEEP BLUE

1921

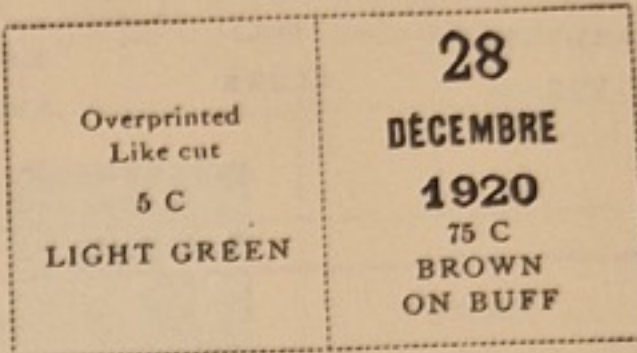

Overprinted
Like cut
5 C
LIGHT GREEN

28
DÉCEMBRE
1920
75 C
BROWN
ON BUFF

1922

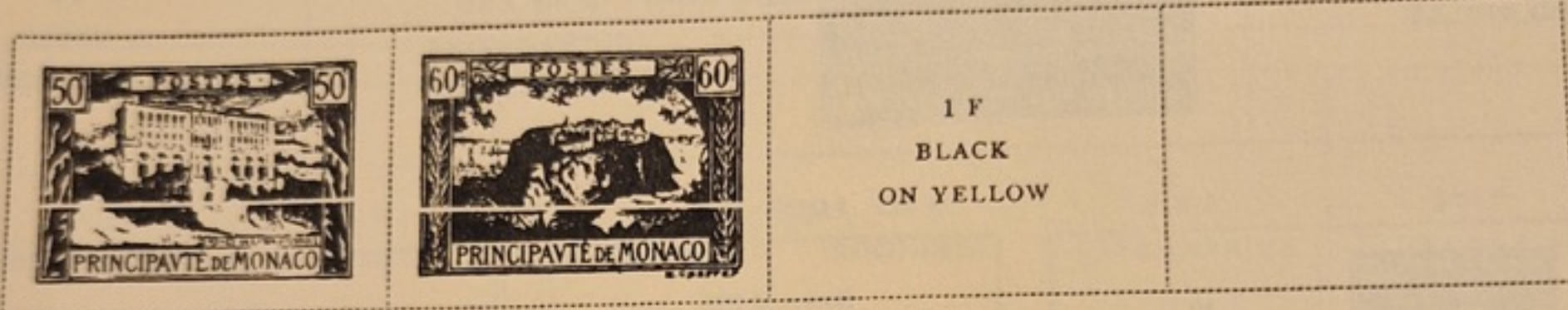

1 F
BLACK
ON YELLOW

1923-24

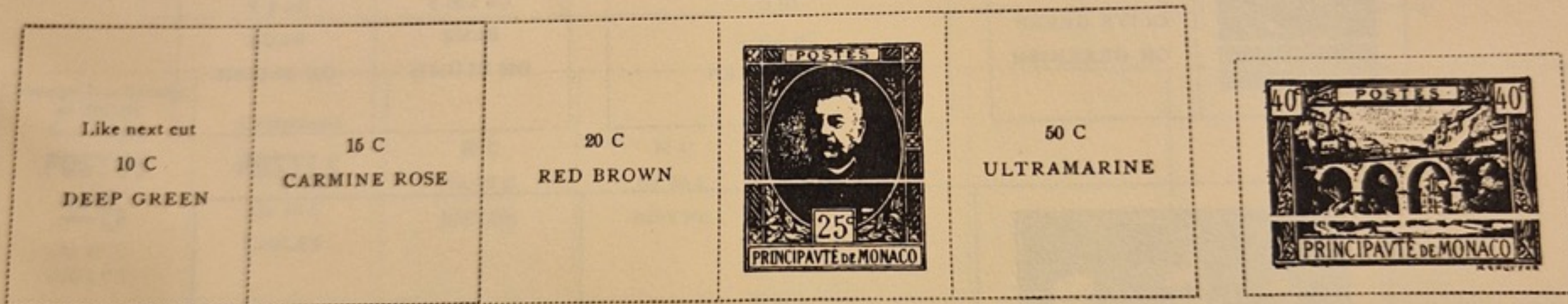

Like next cut
10 C
DEEP GREEN

15 C
CARMINE ROSE

20 C
RED BROWN



50 C
ULTRAMARINE



1924-33

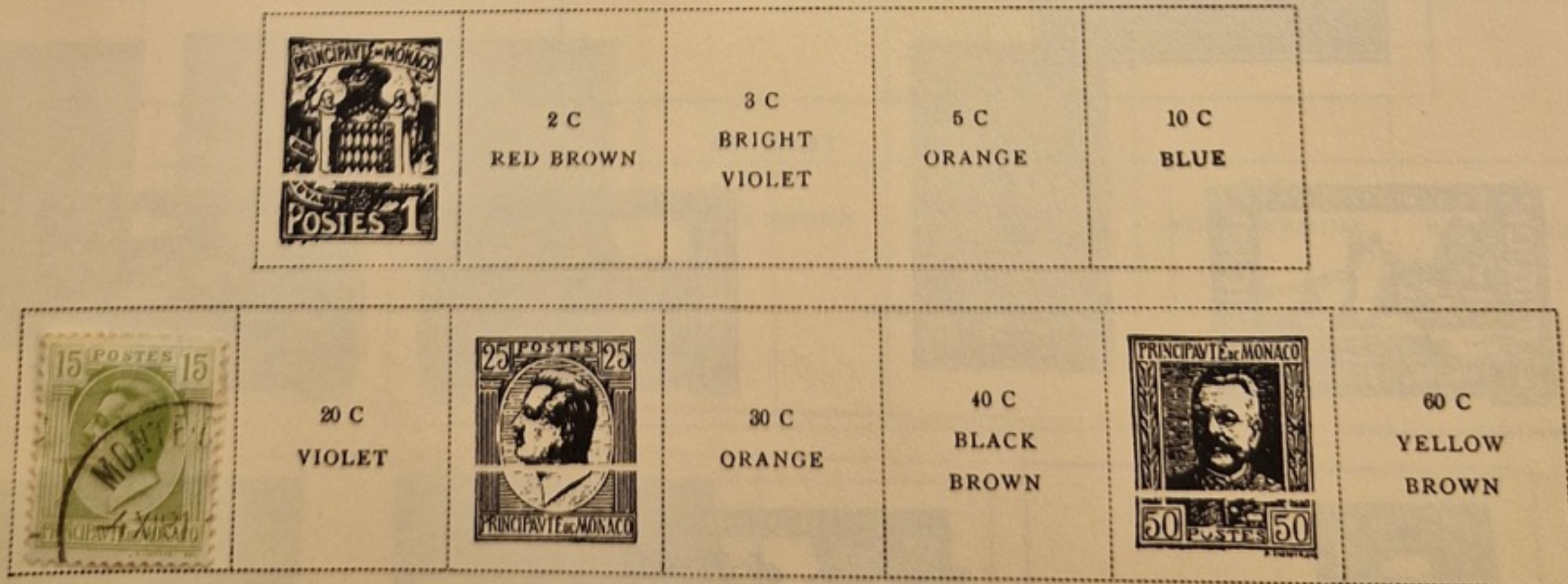

20 C
VIOLET



30 C
ORANGE

40 C
BLACK
BROWN



60 C
YELLOW
BROWN

MONACO

1940-46

Type of 1937-39
10 C
BLACK

30 C
DULL GREEN

40 C
ROSE
CARMINE

50 C
BRIGHT
VIOLET

60 C
PRUSSIAN
BLUE

70 C
RED
BROWN

Types of 1939-40
30 C
BROWN RED

60 C
DARK GREEN



1.30 F
BROWN BLACK

3 F
BLACK

4.50 F
BRIGHT
VIOLET

5 F
DEEP GREEN

10 F
DEEP BLUE

70 C
BRIGHT RED VIOLET



2 F
LIGHT ULTRAMARINE



80 C
DEEP
GREEN

1 F
ROSE
VIOLET

1.20 F
GREEN

1.50 F
VIOLET



MONACO

1946

Types of 1939-43
1.50 F
ULTRAMARINE

2 F
GREEN

4 F
ROSE
LILAC

6 F
LIGHT
VIOLET

1.20 F
ULTRAMARINE

25 F
BLUE
GREEN



MONACO

1946-49



3 F
BRIGHT
RED VIOLET



10 F
BRIGHT
ULTRA-
MARINE



2.50 F
VERMILION

4 F
SLATE
GRAY



1 F
DARK
VIOLET BLUE

5 F
ORANGE
BROWN

6 F
PURPLE

10 F
ORANGE

12 F
DEEP
CARMINE

12 F
DARK
SLATE GR.



18 F
DARK
BLUE

MONACO

1948-49

Types of 1939-43
50 C
SEPIA

60 C
ROSE PINK

3 F
VIOLET
ROSE

4 F
EMERALD

8 F
RED
BROWN

10 F
BROWN
RED

5 F
BLUE GREEN

10 F
ORANGE

20 F
CARMINE ROSE

25 F
GRAY BLACK

25 F
BLUE

40 F
BROWN
ROSE



MONACO

SEMI-POSTAL STAMPS

1942-44



MONACO

AIR POST SEMI-POSTAL STAMPS

1945-48



MONGOLIA

CHINESE DEPENDENCY



MONGOLIA



INDEPENDENT NATION



NAURU



NEPAL



Official



NOUVELLE-GUINÉE ANGLAISE

POSSESSION ANGLAISE DE L'Océanie

1901. Bateau indigène.



1/2 p. vert et noir.

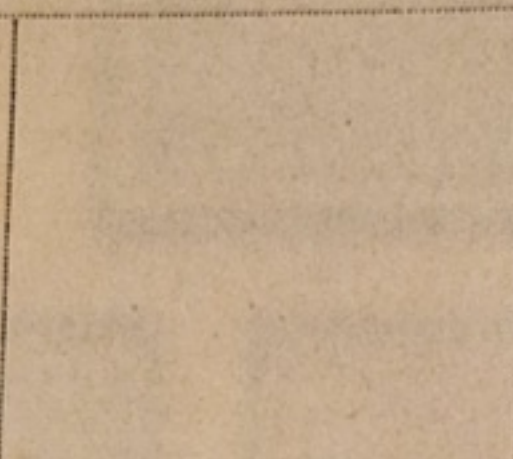

1 p. carmin et noir.

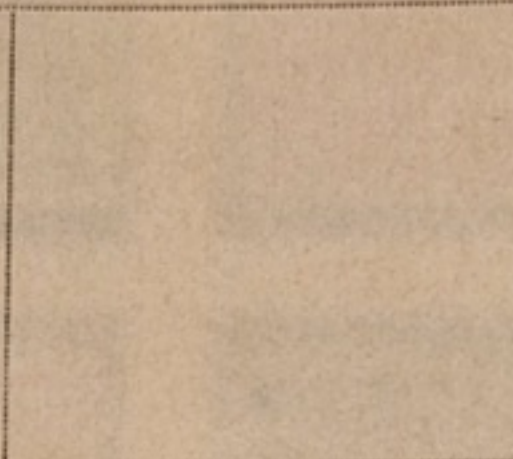

2 p. violet et noir.

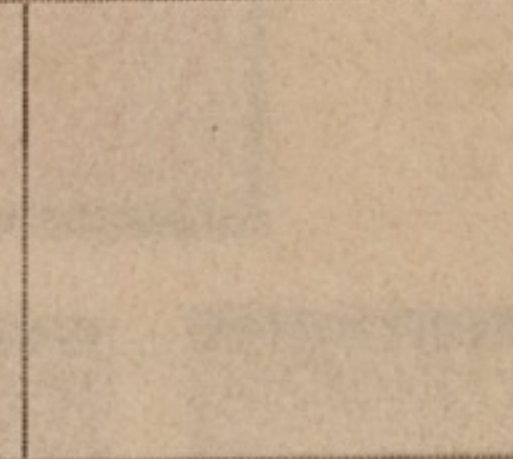

2 1/2 p. bleu et noir.

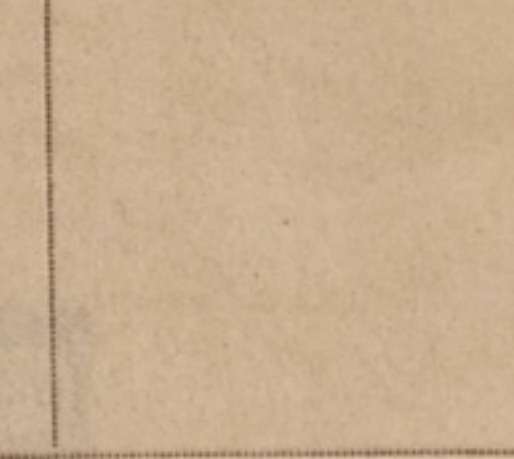

4 p. brun et noir.



6 p. vert foncé et noir.

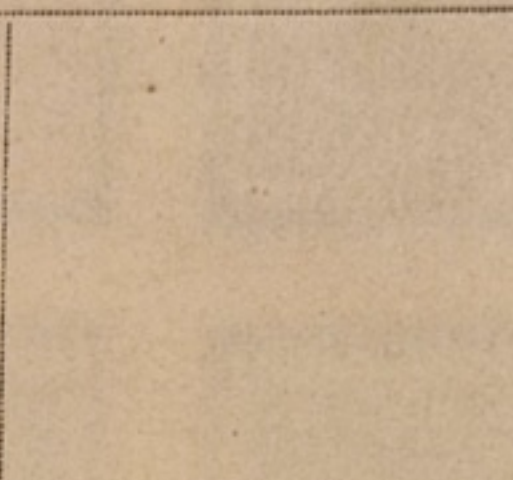

1 sh. orange et noir.

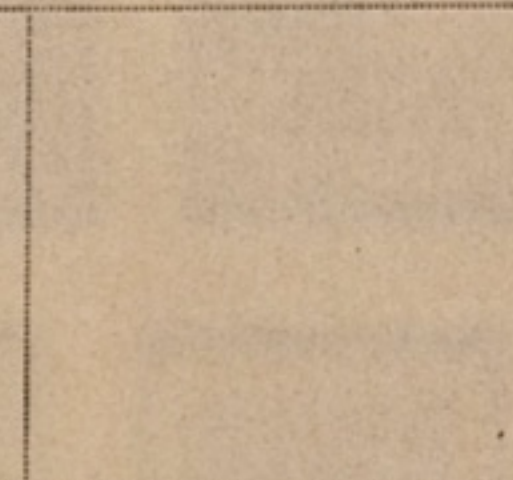

2 sh. 6 p. brun et noir.

NEW GUINEA



Air Post



NEW HEBRIDES

BRITISH ISSUES

Fiji Issues Overprinted
Watermarked Crown and "C A"
1908-09

1/2P



5P

6P

1SH

NEW HEBRIDES

BRITISH ISSUES

Native Idols

Watermarked Multiple Crown and "C A"

1911

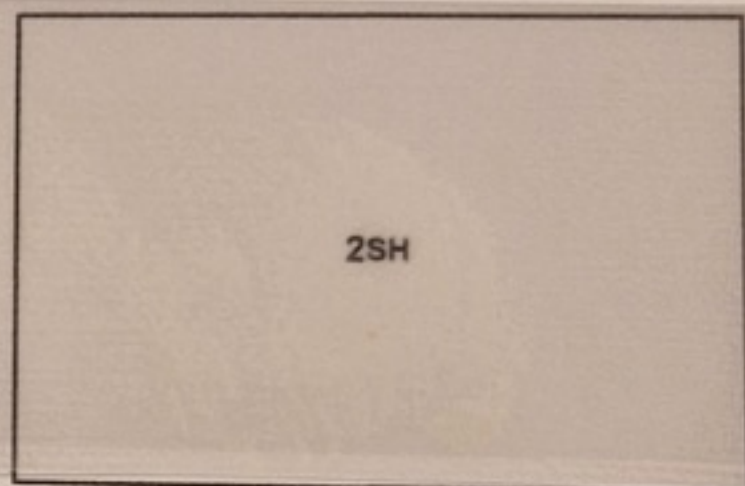
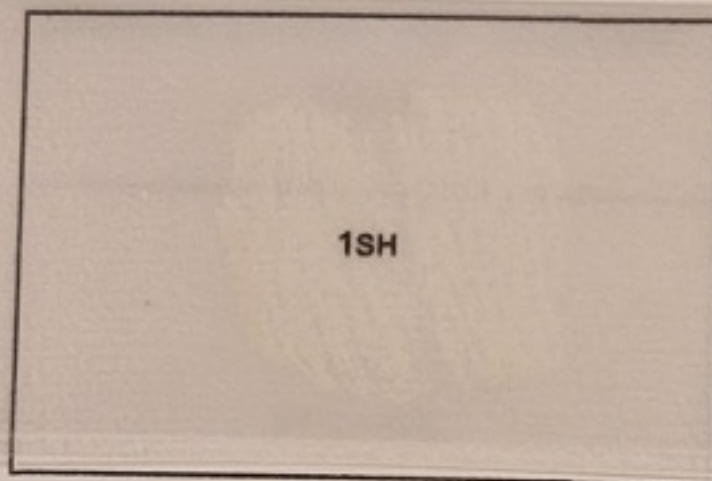
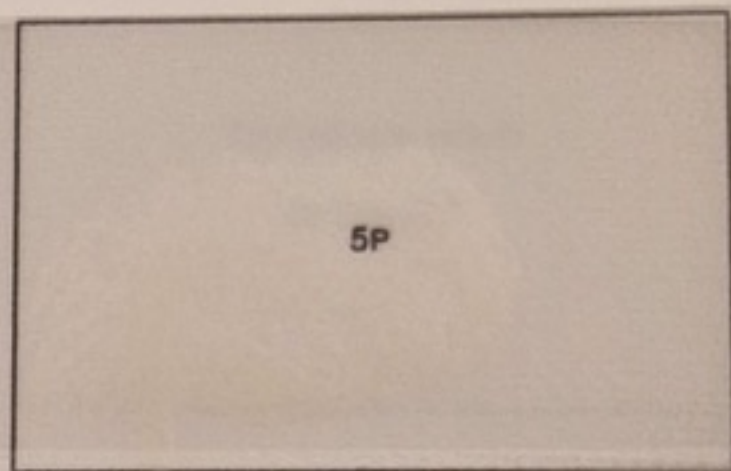
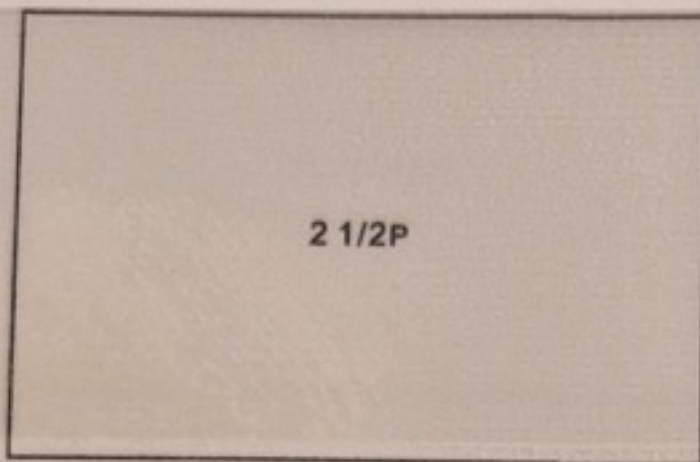
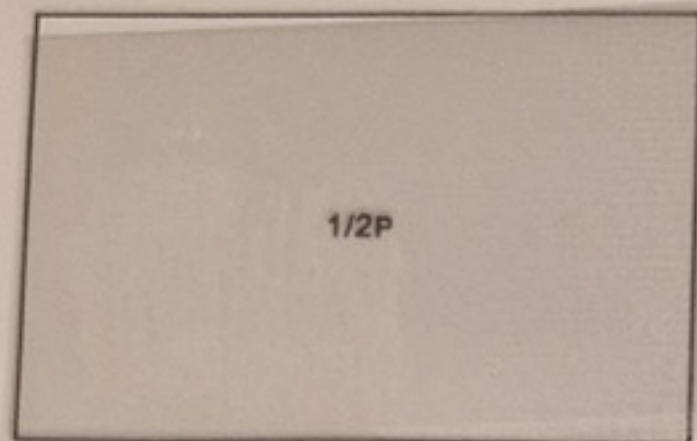

NEW HEBRIDES

BRITISH ISSUES

Previous Issue Surcharged

1920-21



1d.

ON 1SH



1P ON 5SH

ON FRENCH ISSUE

2P ON 40C

NEW HEBRIDES

BRITISH ISSUES

1911-21 Issues Surcharged
Watermarked Multiple Crown and "C A"

1924

1P ON 1/2P

5P ON 2 1/2P

Watermarked Multiple Crown and Script "C A"



Native Idols

1925



2P (20C)

2 1/2P (25C)



6P (60C)

NEW HEBRIDES

BRITISH ISSUES

Beach Scene

1938

5C



15C

20C

25C

30C

40C

50C

1FR



5FR

NEW HEBRIDES

BRITISH ISSUES

POSTAGE DUE STAMPS

Regular Issues of 1953 Overprinted
1953

POSTAGE DUE

5C

10C

20C

40C



MAURITIUS

Queen Victoria

1847

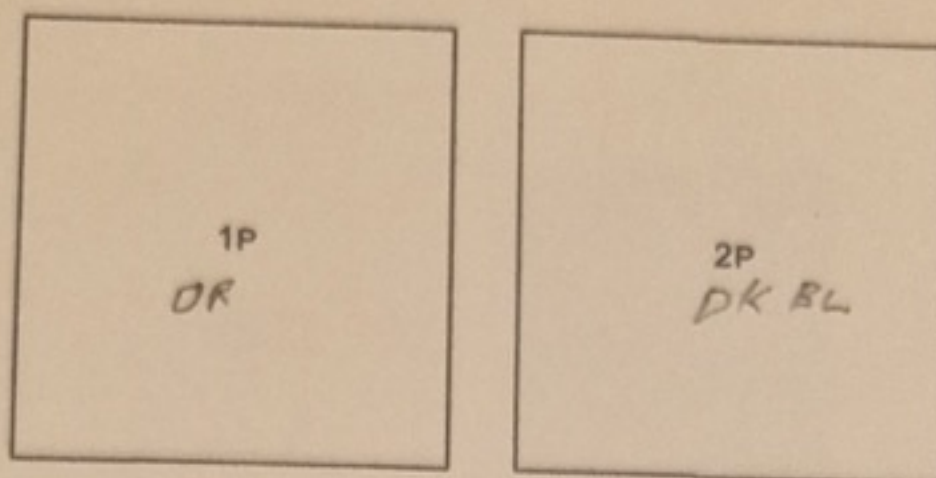

Queen Victoria

1848

Yellowish Paper

Bluish Paper



Britannia
1849-58

Britannia
1858-59



Britannia
Surcharged
1858

Queen Victoria
1859

Queen
Victoria
1859

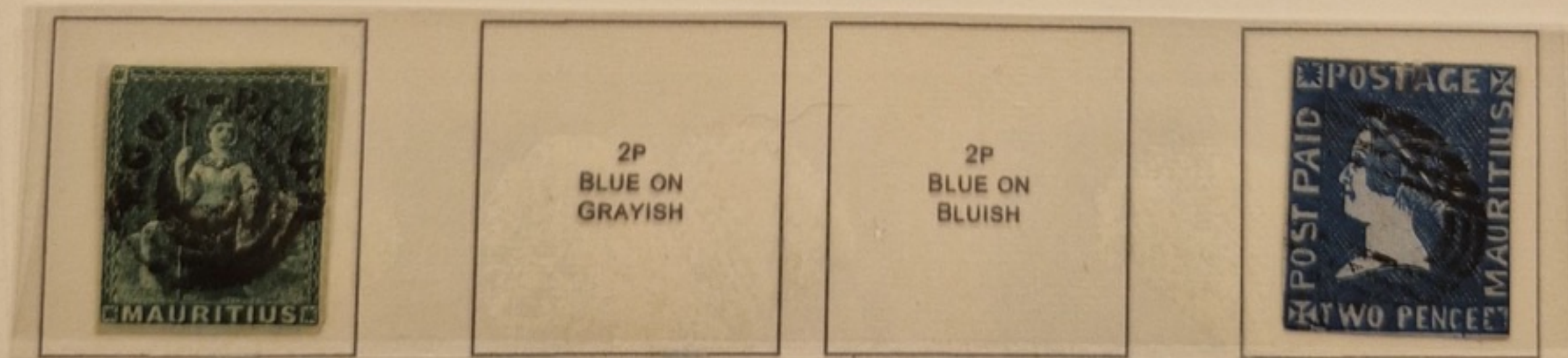

MAURITIUS

Queen Victoria
Imperforate, Laid Paper
1859

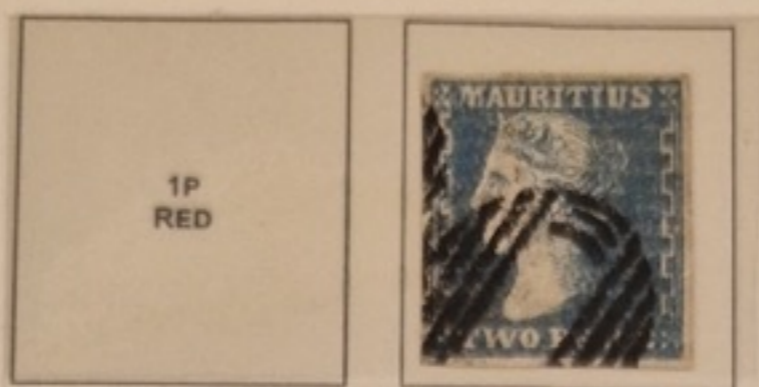

Britannia
Imperforate, Wove Paper
1859

Britannia
Imperforate, Wove Paper
1861



Perforated 14 to 18
1862



Queen Victoria
Unwatermarked, Perforated 14
1860-63



MAURITIUS

Queen Victoria
Watermarked Crown and "C C", Perforated 14
1863-72



Queen Victoria
1872

Stamp of 1860 Surcharged
1876

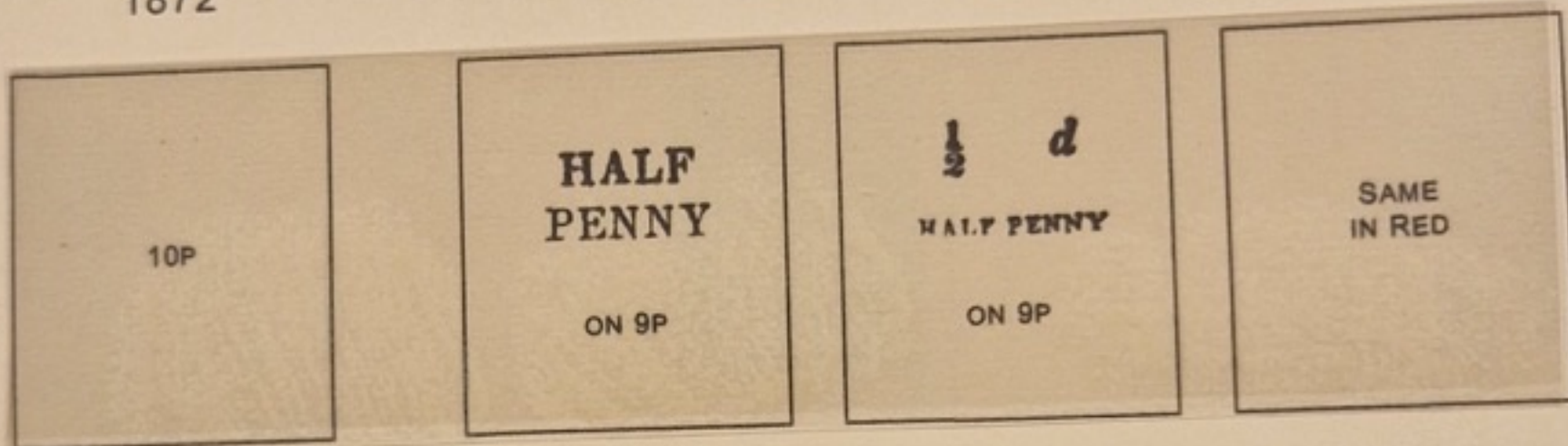

Stamps of 1863-72 Surcharged
1876-77

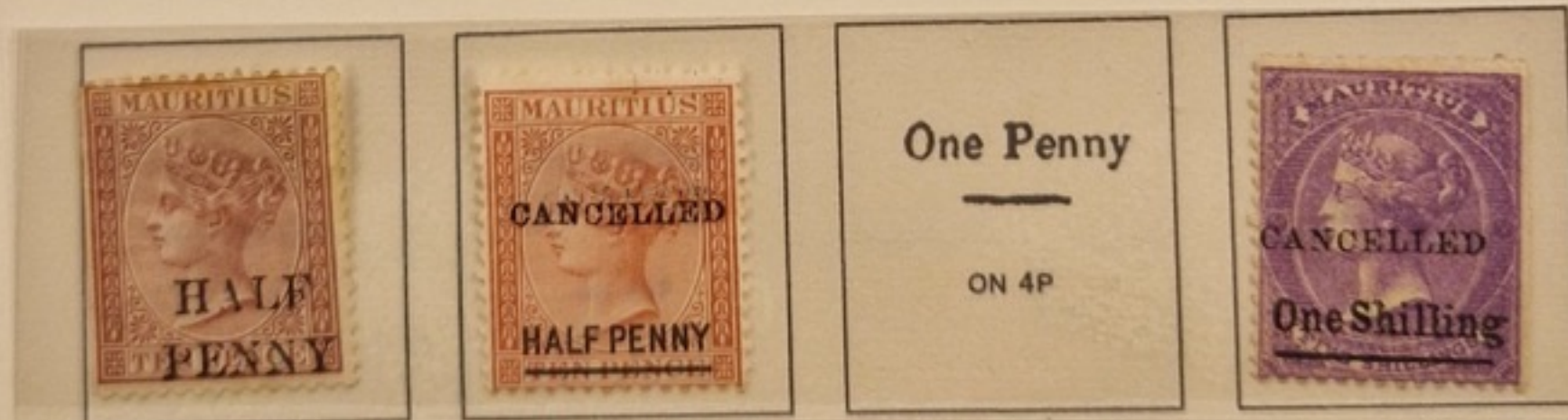

Queen Victoria Stamp Surcharged
1878

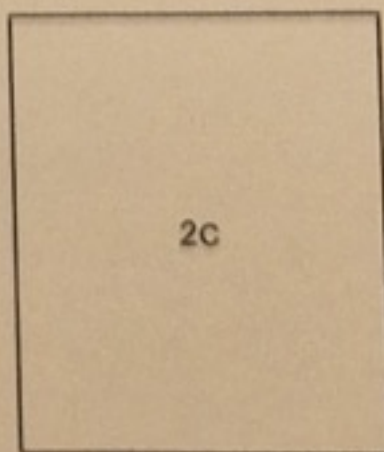

MAURITIUS

Stamps and Type of 1863-72 Surcharged
1878



Queen Victoria
Watermarked Crown and "C C"
1879-80



MAURITIUS

Queen Victoria
Watermarked Crown and "C A"
1882-93



Stamp of 1880 and Type of 1882 Surcharged
1883

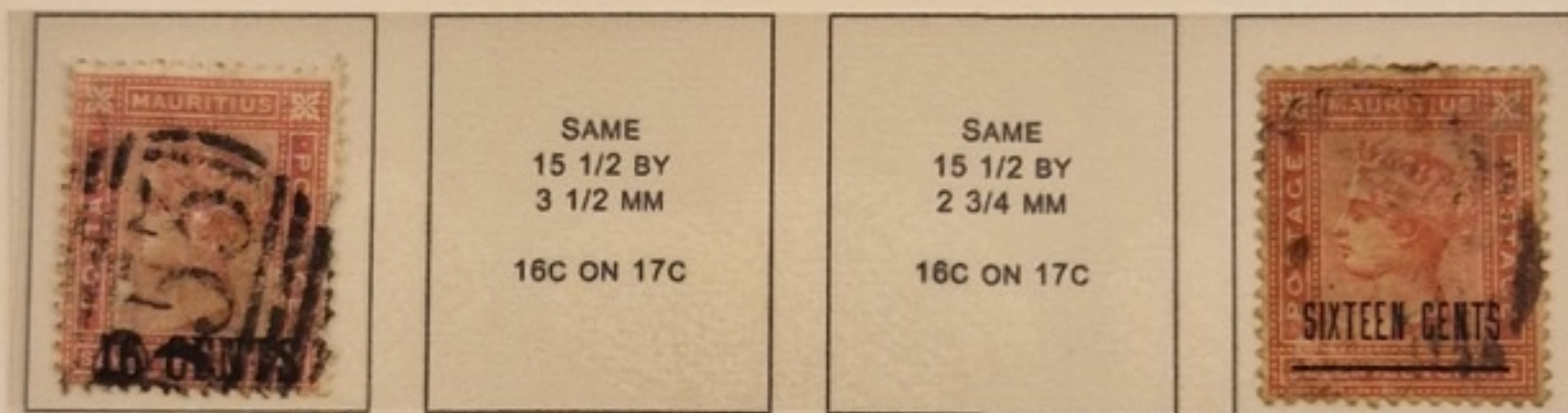

Queen Victoria
1885-94

Surcharged
1885-87



Surcharged
1891

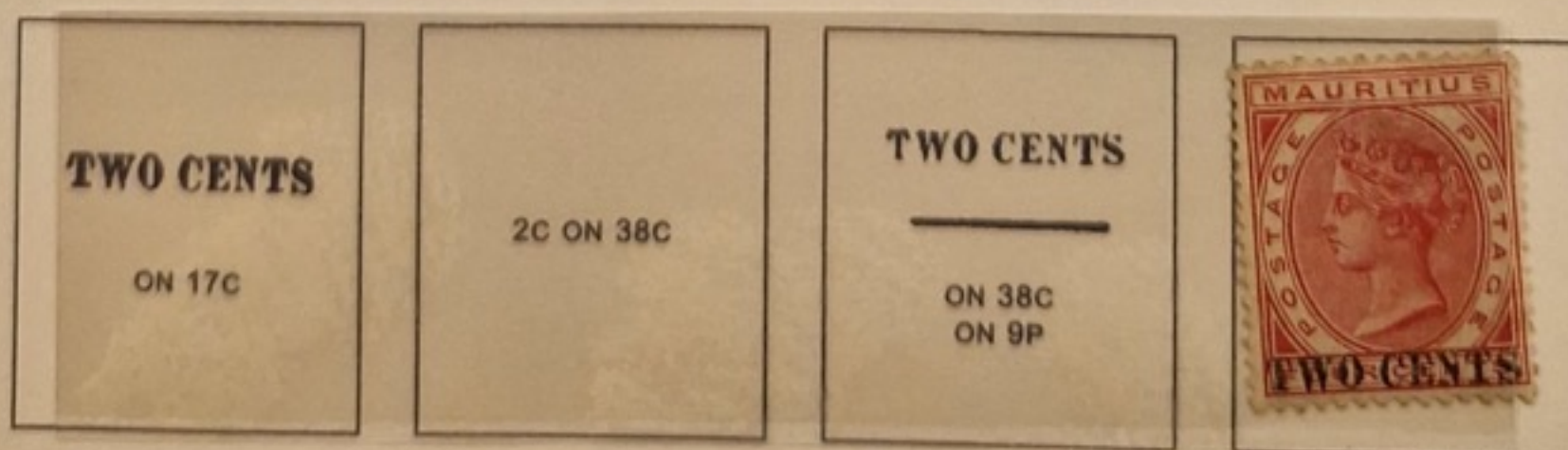

MAURITIUS

Queen Victoria Stamps Surcharged

1893



Coat of Arms

Watermarked Crown and "C A"

1895-1904



15C
GREEN &
ORANGE

18C

50C

MAURITIUS

Diamond Jubilee
1898

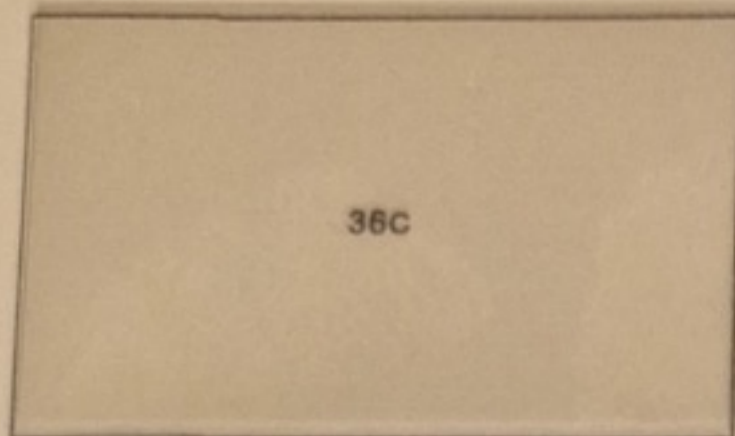

Arms Surcharged
1899



Jubilee Stamp Surcharged
1899



Admiral Mahe de La Bourdonnais
1899

Victoria Stamp
Surcharged
1900

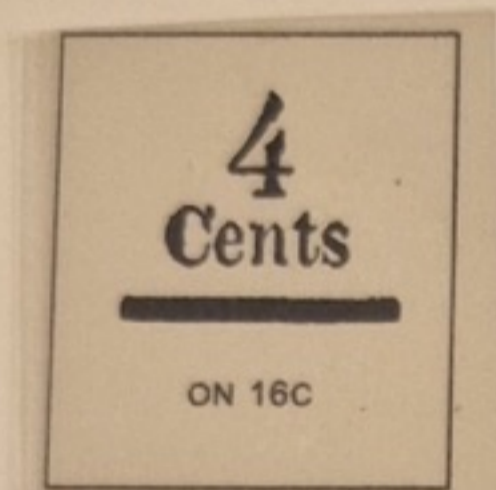

Arms Stamp
Surcharged
1902



Previous Issues Overprinted
1902

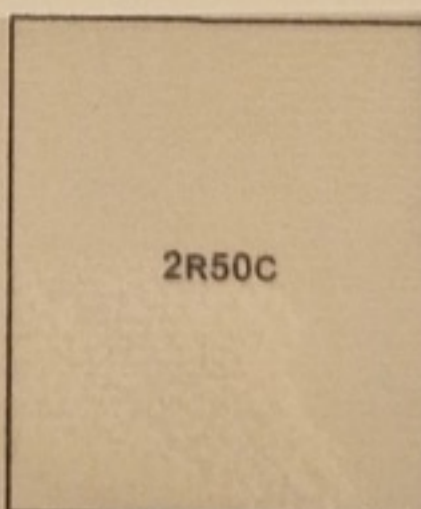

MAURITIUS

Coat of Arms

1902



Diamond Jubilee Stamp Surcharged

1902



Coat of Arms Type of 1895-1904
Watermarked Multiple Crown and "C A"

1904-07



MAURITIUS

Coat of Arms, Edward VIII
Watermarked Multiple Crown and "C A"
1910

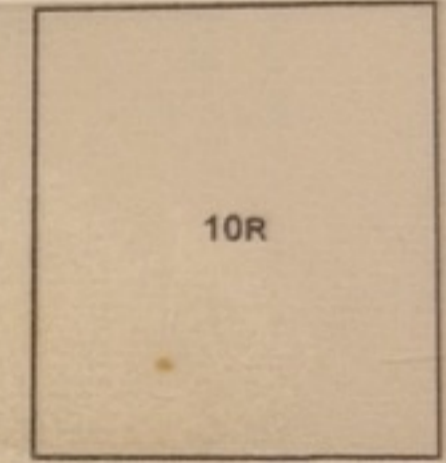
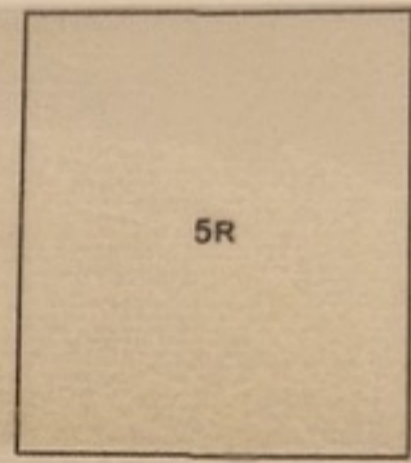
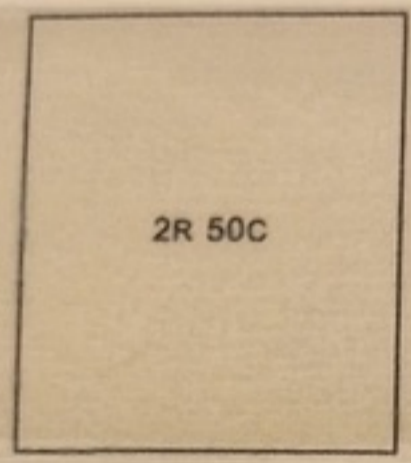
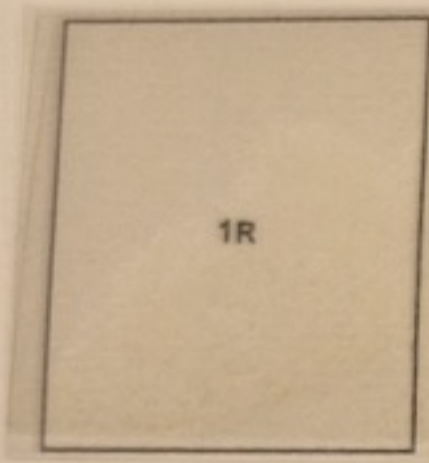
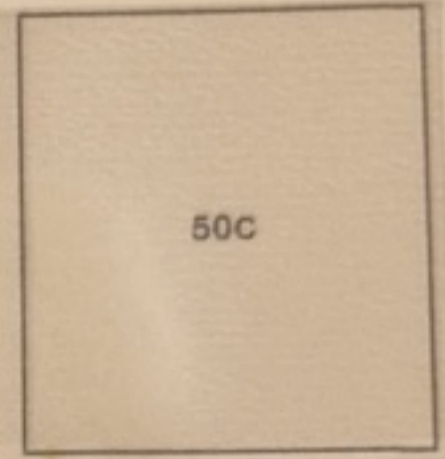
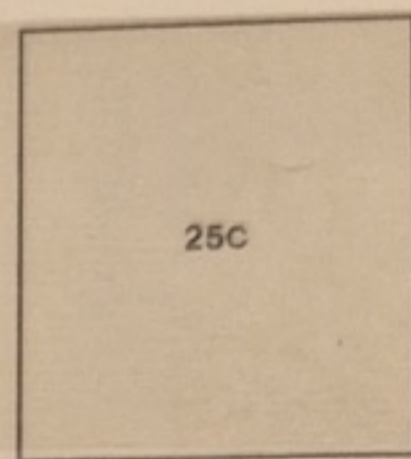

King George V
Watermarked Multiple Crown and "C A"
1912-22

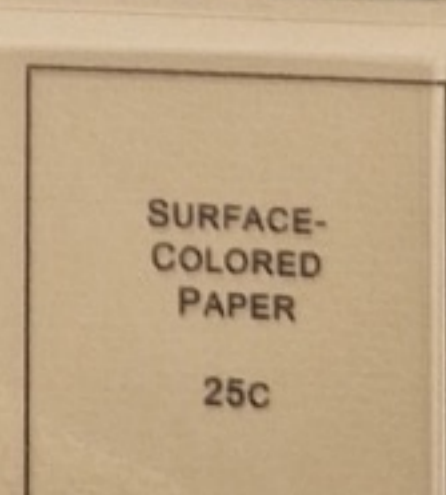
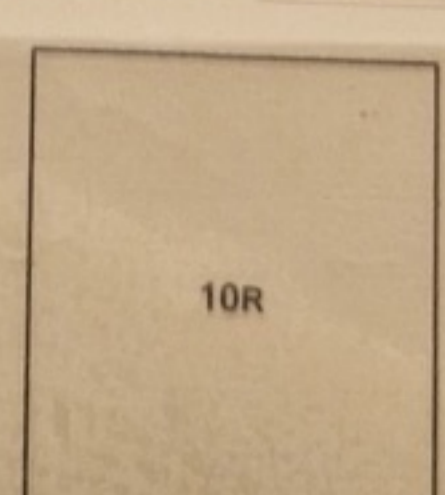
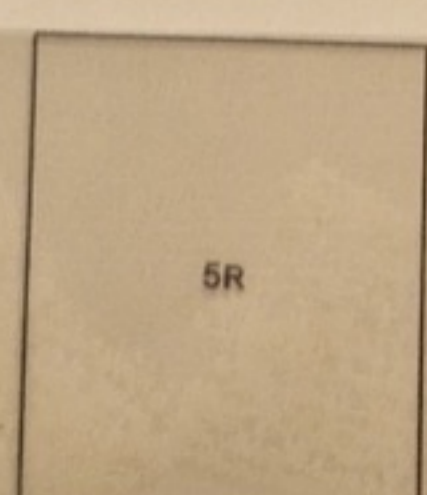
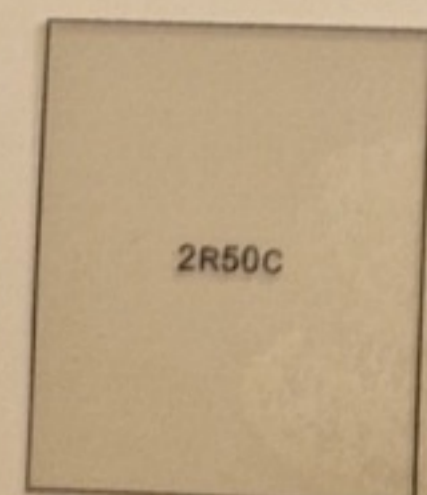
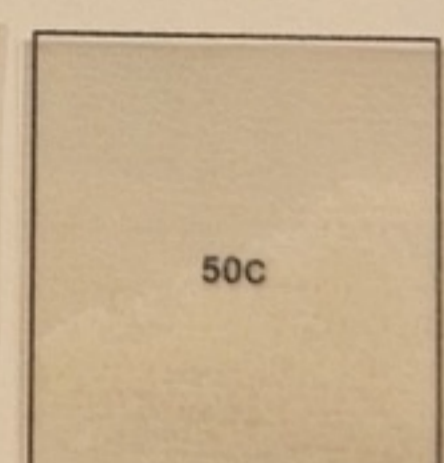
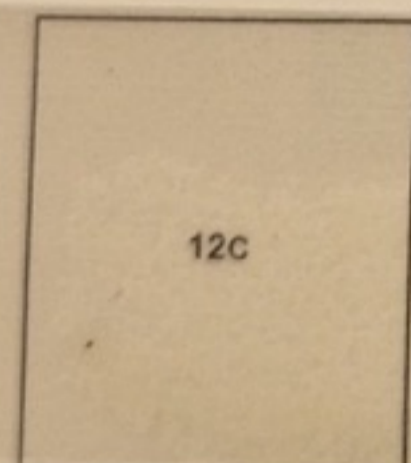

MAURITIUS

Coat of Arms

Watermarked Multiple Crown and Script "C A"

1921-26

1C



2C
VIOLET ON
YELLOW



4C
BROWN

6C
ROSE RED



8C

10C
GRAY



12C
ROSE RED

12C
GRAY

15C
ULTRA.



20C
DULL VIO.

MAURITIUS

King George V

Die II, Watermarked Multiple Crown and Script "C A"

1922-34

1c



4c
OL. GREEN
& RED



8c



12c
LARGER "C"

12c
ROSE RED

15c



50c



2R50c

5R

10R

MAURITIUS

Coat of Arms
1924



Arms Stamps of 1921-22 Surcharged
1925

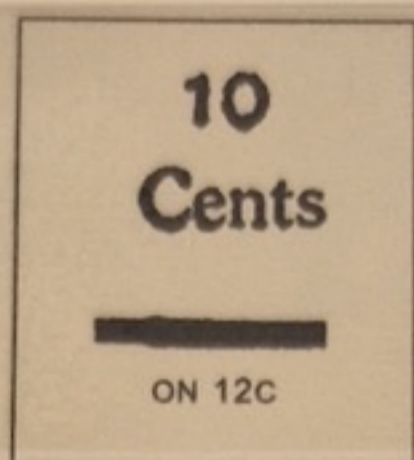
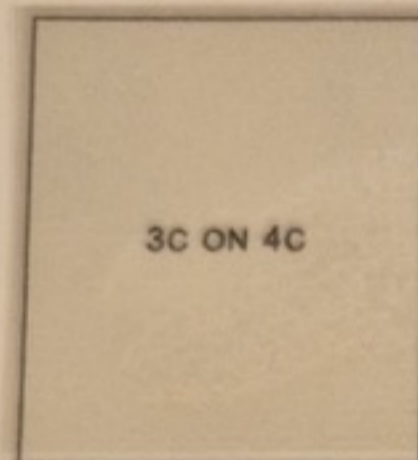

Silver Jubilee
1935



MAURITIUS

Coronation
1937



King George VI
1938-43



Peace
1946



MAURITIUS

Centenary of the First Mauritius Postage Stamps

1948



MAURITIUS

SPECIAL DELIVERY STAMPS

Admiral de La Bourdonnais Stamp Surcharged

1903

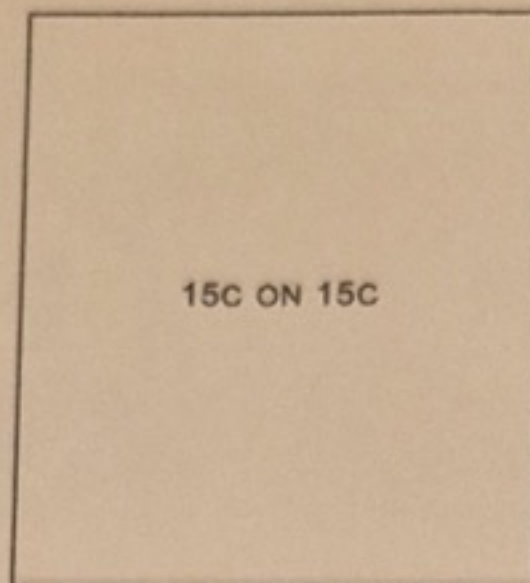

Admiral de La Bourdonnais Stamps Surcharged

1904

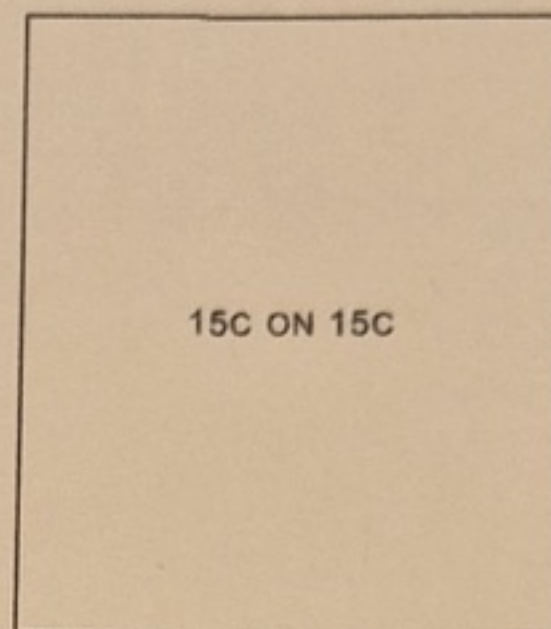
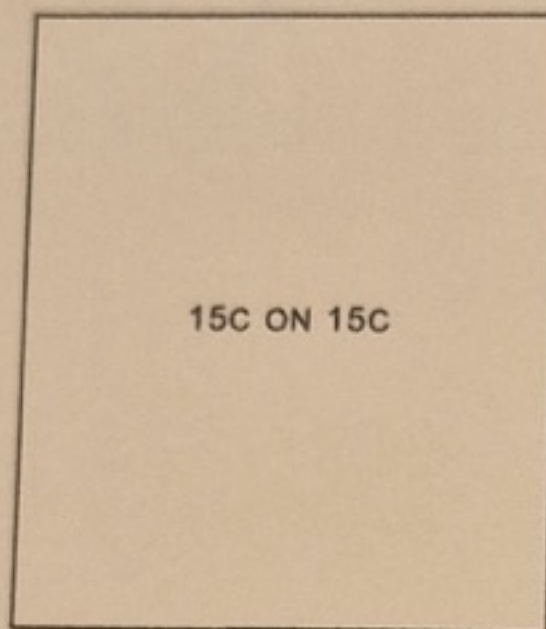

Coat of Arms Types Surcharged

1904



MAURITIUS
POSTAGE DUE STAMPS

Numerals

Watermarked Multiple Crown and Script "C A"

1933-54



NEW ZEALAND

Queen Victoria - Full Face Queen
London Printing, Imperforate, Watermarked Large Star
1855



Auckland Printing, Imperforate, Blue Paper, Unwatermarked
1855-58



Imperforate
White Paper, Unwatermarked
1858-61

White Patch of Wear
at Right of Head
1863



Imperforate, Pelure Paper, Unwatermarked
1862

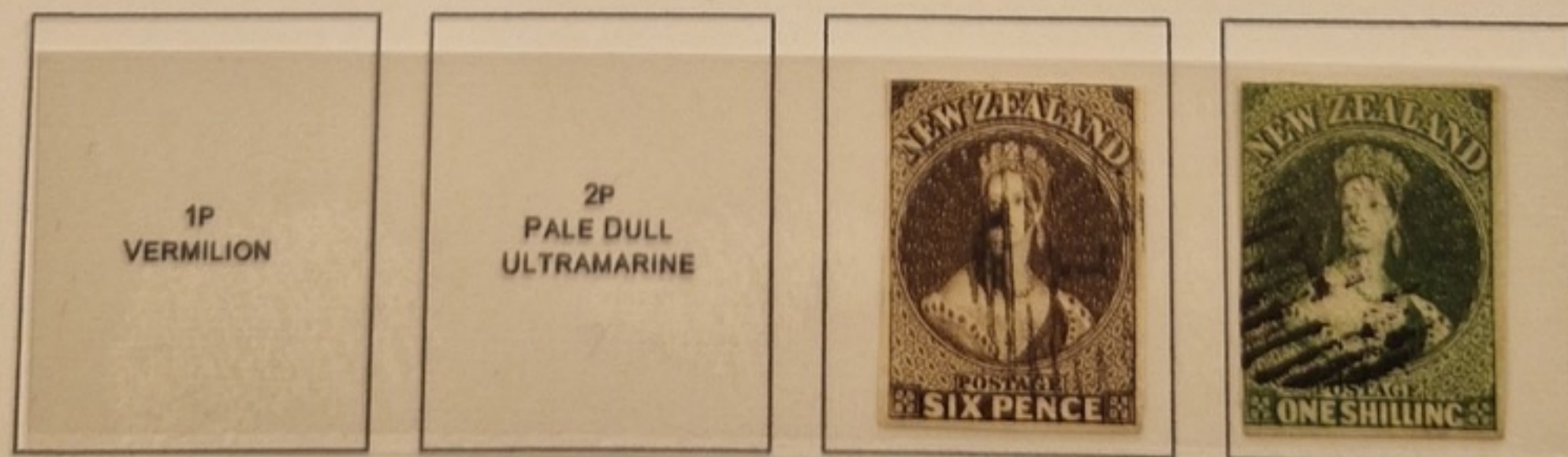

NEW ZEALAND

Queen Victoria - Full Face Queen
Imperforate, Watermarked Large Star
1862-63

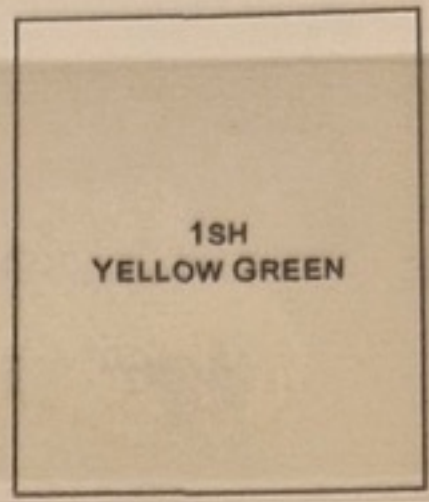
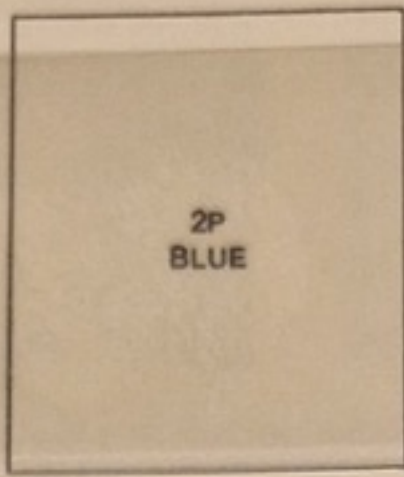
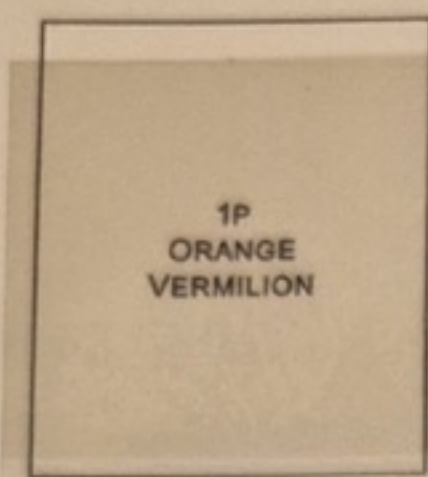

Imperforate, Watermarked "N Z"
1864

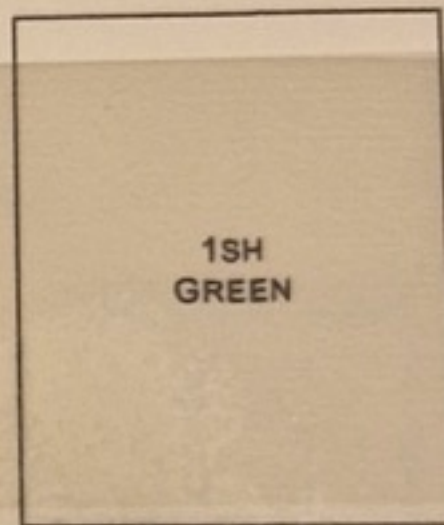
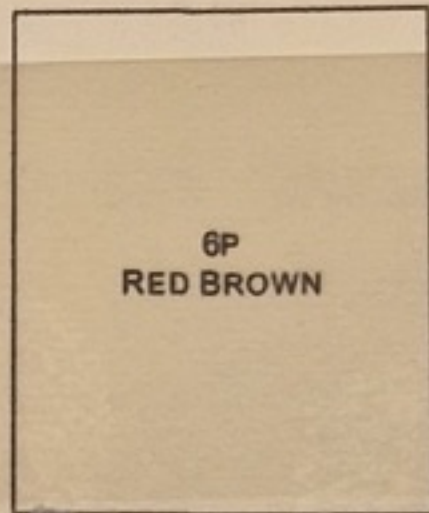
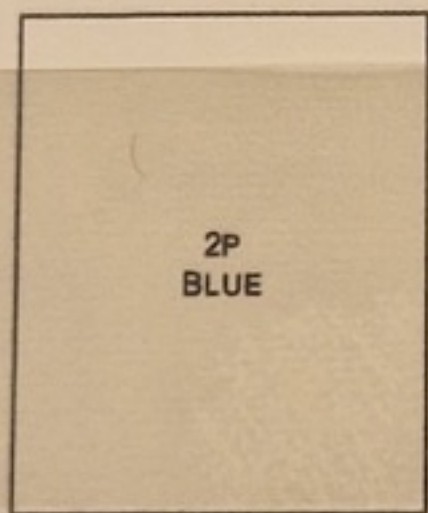
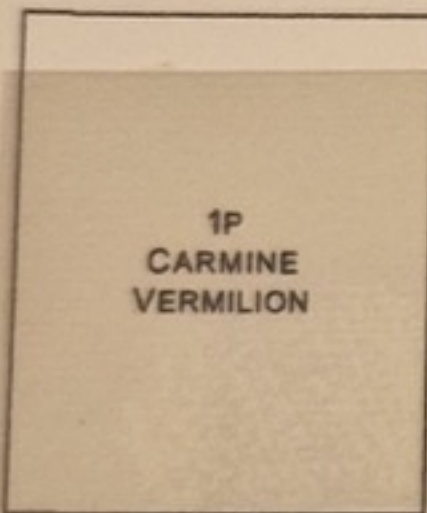

NEW ZEALAND

CROWN COLONY



DOMINION OF NEW ZEALAND



NEW ZEALAND



NEW ZEALAND



Semi-Postal



Special Delivery



NEW ZEALAND

ROSS DEPENDENCY



NEW ZEALAND

1855-74



1882



1891-95

1901



1898-1907



1906



NEW ZEALAND

1909-12

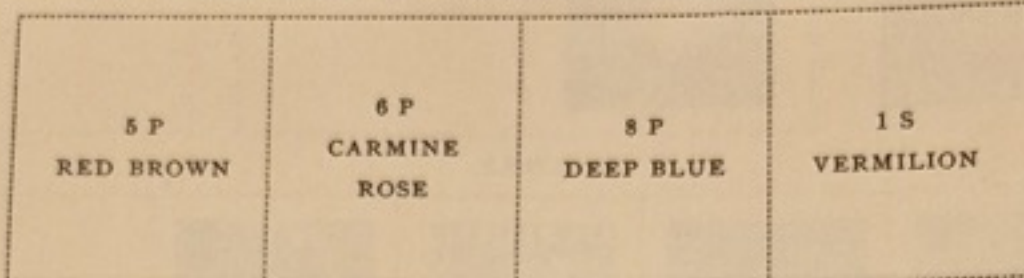
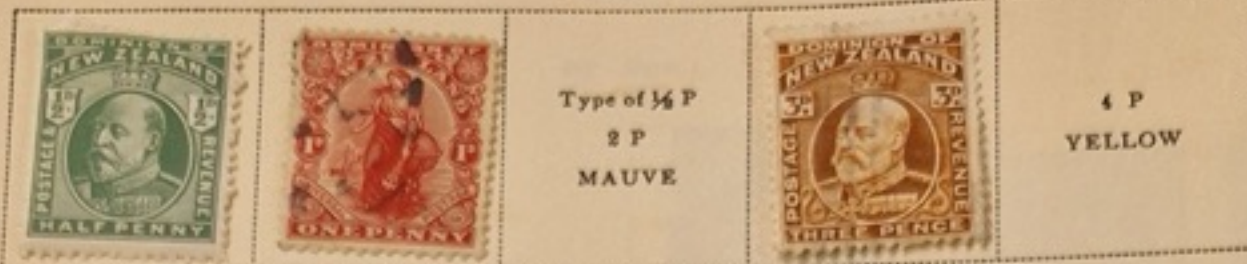

1915-22

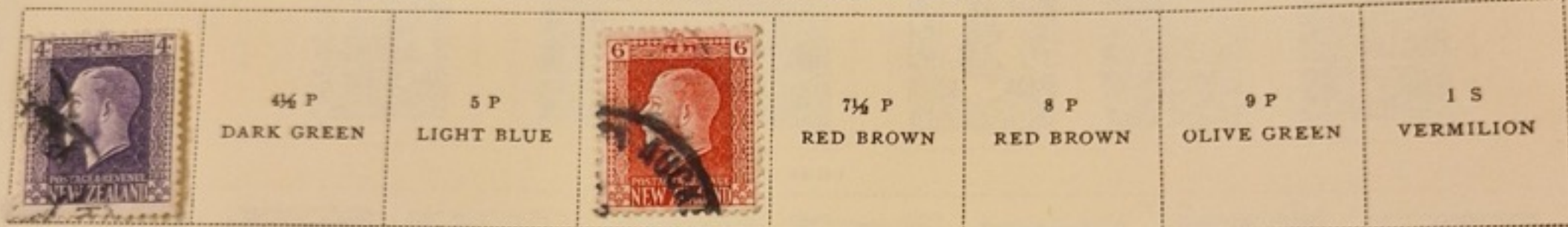
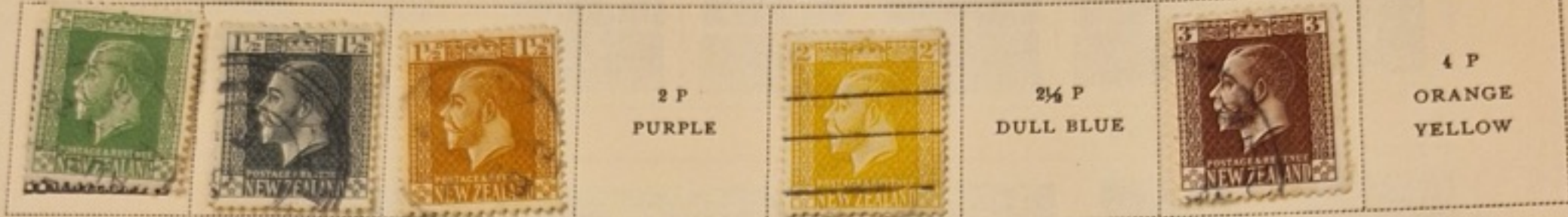

1919



1919

1921-22

1923



Victory Stamp of 1919
Surcharged
2d. 2d.
TWOPENCE
On 1/2 P
YELLOW GREEN



1925

1926

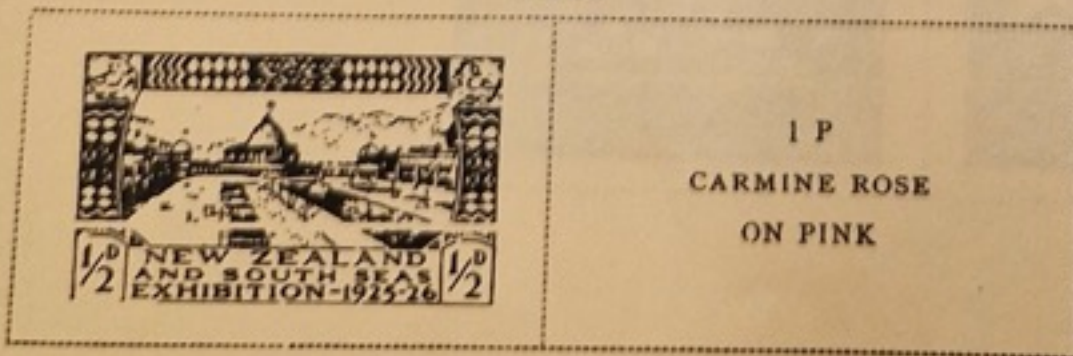

ALBUM PAGE

NEW ZEALAND

1935



1936



1937



1938

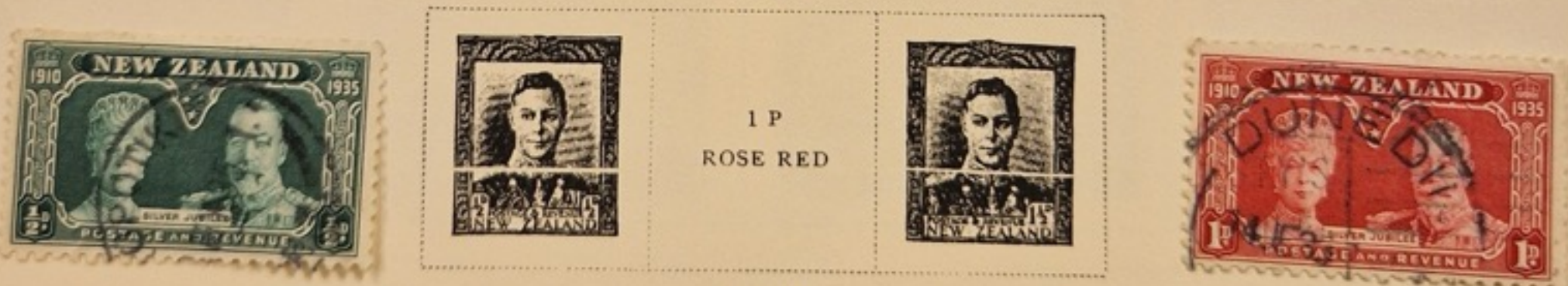

1940



NEW ZEALAND

1941



Type of 1935
9 P
INTENSE
BLACK
AND
SCARLET



1941-44



1/4 P
RED



1946



NEW ZEALAND

1947-48

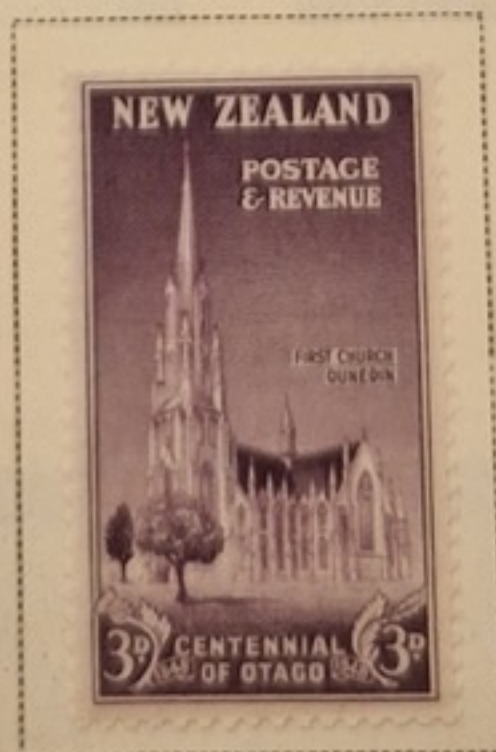

NEW ZEALAND

SEMI-POSTAL STAMPS

1940-42

Type of 1939
Without Surcharge

1 P + 1/2 P
GREEN

2 P + 1 P
ORANGE
BROWN

Same
Overprinted
"1941"

1 P + 1/2 P
GREEN

3 P + 1 P
ORANGE
BROWN



1943-48



NEW ZEALAND

AIR POST STAMPS

1931



4 P
DARK VIOLET

7 P
ORANGE

Same Surcharged
FIVE PENCE
On 3 P
YELLOW GREEN

1935



3 P
DARK VIOLET

4 P
GRAY BLUE

NEW ZEALAND

WAR TAX STAMP

1915



NEW ZEALAND

POSTAGE DUE STAMPS

1900

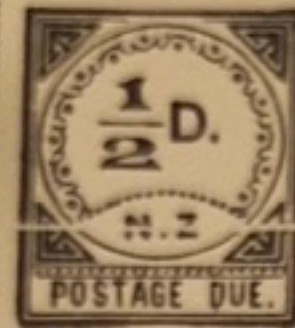

1 P
GREEN
AND RED

2 P
GREEN
AND RED

3 P
GREEN
AND RED

1902-28



1 P
GREEN AND
CARMINE

2 P
GREEN AND
CARMINE

3 P
GREEN
AND ROSE

NEW ZEALAND

OFFICIAL STAMPS

1940

Regular Stamps of 1940
Overprinted
Official
 $\frac{1}{4}$ P
DARK BLUE GREEN

1 P
SCARLET
AND SEPIA

$\frac{1}{4}$ P
BRIGHT VIOLET
AND ULTRAMARINE



$\frac{2}{4}$ P
DARK BLUE
AND MYRTLE
GREEN

4 P
DARK RED VIOLET
AND VIOLET BROWN

NEW ZEALAND

OFFICIAL STAMPS

1907



1910



1915-19

Stamps of 1909-19
Same Overprint
1/2 P
GREEN



NIUE

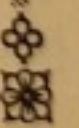

NIUE

1902-03



1911-12

1917-21

New Zealand Stamps of 1909-16 Overprinted Like cut Typographed 1/2 P YELLOW GREEN	NIUE. 1 P CARMINE	1 1/4 P BROWN ORANGE	2 1/4 P DULL BLUE	3 P CHOCOLATE	6 P CARMINE ROSE
---	--------------------------------	----------------------------	----------------------	------------------	------------------------

1920



1920



1932



1932



1940



1937

Stamps of New Zealand 1937 Overprinted NIUE 1 P ROSE CARMINE	2 1/4 P DARK BLUE
--	----------------------



NORFOLK ISLAND

