



1925;5m  
Broken  
Stylus



1926;5m  
Unrecorded  
Broken  
Frame



1925;10m  
Connected  
Arabic  
Character



1926;15m  
Unrecorded  
White Flaws  
Lower Panel



1926;200m  
Unrecorded  
White Loop  
Above Ox



1926;100m  
Inverted  
W/K



1926;5m  
Unrecorded  
Broken Frame  
Upper Left



1926;10m  
Joined  
Dots



1926;5m  
Blotted "Y"



1926;15m  
Closed  
Loop



1926;10m  
Unrecorded  
Red Blotch



1926;10m  
White  
Bulge



1927;15m  
Unrecorded  
Colored Dot  
Upper Left  
Corner



1928;5m  
Background  
Stripes



1927;10m  
Large Spot



1928;10m  
"F" instead  
of "E"



1929;5m  
Retouch  
In Front  
of Jacket



1929;10m  
Unrecorded  
Blotch  
at Left  
of Prince



1929;15m  
Unrecorded  
Turquoise  
Frame



1929;20m  
Unrecorded  
Blotch  
at Right  
of Prince



1931;5m  
Unrecorded  
Broken Frame  
Lower Left



1931;10m  
Unrecorded  
Red Blotch  
at Right  
Frame



1931;15m  
Unrecorded  
Broken Plate  
at Arabic  
Value



1936;10m  
Unrecorded  
Extra Flag  
Pole over  
Building



1936;10m  
Unrecorded  
Mirror  
Image



1937;15m  
Unrecorded  
Mirror  
Image



1943;Ferial  
Unrecorded  
Shifted o/p



1944;10m  
Unrecorded  
Vertical  
Line



1944;10m  
Unrecorded  
Dot Over  
Forehead



1944;10m  
Unrecorded  
Dot Over  
Ear



1944;10m  
Dot Across  
Eye



1945;10m  
Unrecorded  
Dot Over  
"O" of Postes



1945;10m  
Unrecorded  
Misprint



1946;17m  
Unrecorded  
Crack in  
Value



1946;30m  
Unrecorded  
Missing Dot



1946;10m  
Unrecorded  
Blotch on  
Flag

1946;30m  
Unrecorded  
Twisted "L"



1946;10m  
Unrecorded  
Dot Beside  
Ear



1946;4m  
Broken "E"



1946;10m  
Green Line  
Over Sleeve



1949;17m  
Dot in Sky



1947;50m  
Dark Line



1949;22m  
Unrecorded  
Mirror  
Image



**1948;13m/100m  
SAIDE  
Unrecorded  
White Blotch**



**1948;13m/100m  
SAIDE  
Missing  
Periods  
NP C119a**



**1948;13m/100m  
SAIDE  
Misplaced o/p  
NP C119b**



**1948;22m/200m  
SAIDE  
Broken "8"  
forming "C"  
Mint & Used**





1949;30m  
Prefolded  
Paper



1949;30m  
Prefolded  
Paper  
Strip of 5



1949;10m  
Dot Under  
"Mixte"



1950;10m  
Dot Over  
Oval



1951;10m  
Unrecorded  
Dot Over  
Head



**1952;10m  
Colored  
Dot in  
Map**



**1952;22m  
Unrecorded  
Oval  
Shifted**



**1952;10m  
Colored  
Dot near  
Wing**



**1953;10m  
Unrecorded  
Blue Dot**



1954;10m  
Dot on Map



1954;30m  
Prefolded  
Paper



1954;10m  
Unrecorded  
Blotch Left  
of Map



1954;35m  
Unrecorded  
Red Vert.  
Line



1954;10m  
Unrecorded  
Green Vert.  
Line



1954;35m  
Unrecorded  
Red Color  
Misplaced  
to Left



**1954;5m  
Unrecorded  
White Dot  
Under "E"  
of Egypt**



**1955;10m  
Photographic  
Essay**



**1955;5m  
3 Dots  
Instead  
of 2**



**1955;5m  
Closed  
Arabic "5"**



**1955;10m  
Stroke Over  
Globe**



**1955;10m  
Unrecorded  
Extra Black  
Character  
at Left**



1957;15m  
Unrecorded  
Missing  
Year



1957;20m  
Unrecorded  
Missing  
Year



1957;100m  
Unrecorded  
Misperforate



1957;10m  
Dot Over  
Frame



1957;10m  
Torn Scroll



1957;10m  
Unrecorded  
"1937"  
Instead of  
"1957"



1957;10m  
Inverted  
w/k

1957;10m  
Inverted  
w/k





**1957;Set  
Inverted  
Watermark**



**1957;Set  
Inverted  
Watermark**



**1957;Set  
Unrecorded  
Misperforate**



**1957;10m  
Inverted  
Watermark**



**1957;10m  
Unrecorded  
Misperforate**



**1957;15m  
Inverted  
Watermark**



**1957;10m  
Inverted  
Watermark**



**1958;5m+10m  
Unrecorded  
Extra  
Orange Dot**



1958;10m  
Unrecorded  
2 Blue Horiz.  
Lines

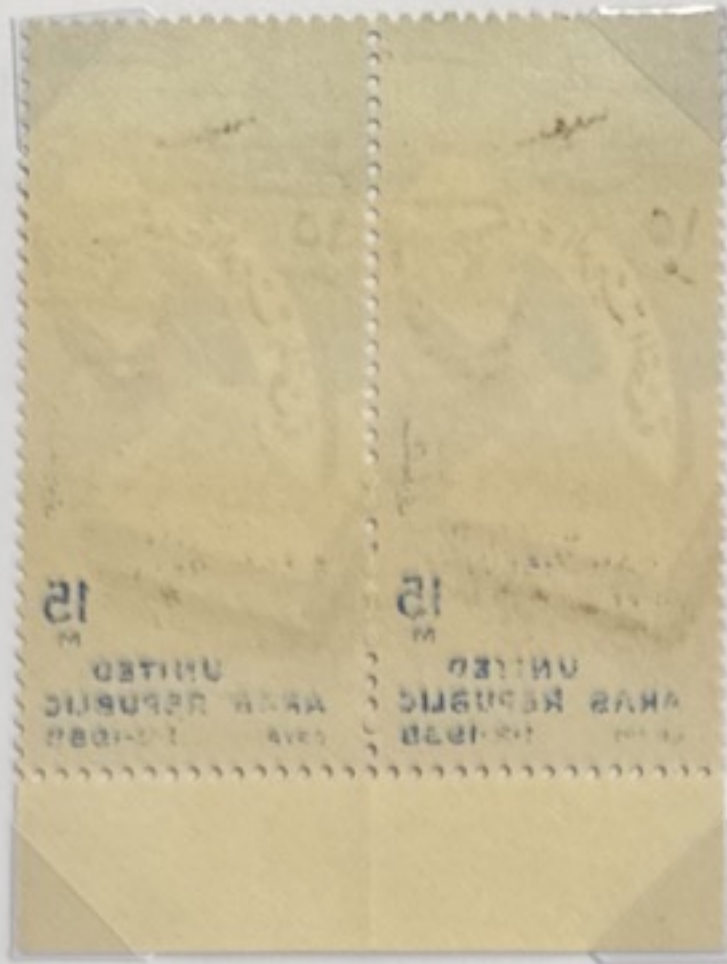

1958;15m  
Unrecorded  
Mirror  
Image



1958;10m  
Unrecorded  
Misperforate



1958;10m  
Inverted  
Watermark



1958;35m  
Unrecorded  
2 Extra  
Horns



1958;35m  
Retouch  
Over  
Arabic "35"



1958;10m  
Inverted  
Watermark



1958;Set  
Inverted  
Watermark



**1958;Flags  
Experimental  
Printing**



**1959;10m  
Unrecorded  
Colored Dot  
Infront of  
Eagle**

**1959;5m+10m  
Inverted  
Watermark**



**1959;10m  
Inverted  
Watermark**



**1958;10m  
Red Color  
Shifted  
to Left**



**1959;10m  
Unrecorded  
Black Dot  
Canceling  
Value**



1959; 10m  
Inverted  
Watermark



1959; 10m  
Extra Dot  
Over Arabic



1959; 10m  
Broken "1"  
of Arabic  
"1859"



1959; 10m  
Retouch



1959  
Essay  
Without  
Value



1959; 10m  
Moon Over  
Museum



1959  
Essay  
Without  
Value



1962; 35m  
UAR  
Watermark



1960; 10m  
Unrecorded  
Grey Line



1960; 10m  
Red Color  
Misplaced



**1960; 10m  
Inverted  
watermark**



**1963  
KIMA  
Essay  
Misperforate**

**1965; 10m  
Unrecorded  
Green Blotch**



**1963; 4m  
"1913"  
Instead of  
"1963"**



**1963  
KIMA  
Essay**



د. م. م. م. م. م.  
١٩٦٨

4 7 1 9 . 6

21 X 63



**1970;20m**  
**Unrecorded**  
**Retouch**

**1968;10m**  
**Part of**  
**"1968" is**  
**Missing**



**1973;20m+10m**  
**Unrecorded**  
**Misprint**



**1978;20m**  
**Turquoise**  
**Color**  
**Instead of**  
**Green**



**1980;20m**  
**Missing**  
**Arabic**  
**Value**  
**Mint & Used**



**1985;5pi**  
**Missing "1"**  
**of "1985"**



1979;140m  
Unrecorded  
Green  
Shifted



1983;3pi  
Unrecorded  
Double  
Perforation



1986;5pi  
Emerald  
Misplaced  
to Right

25 مصر 1984



4 1 0 8 7

791

1984;3pi  
"Egypt"  
Misplaced  
to Left



1987;5pi  
3 Different  
Colors



1987;15pi  
Blue Color  
Shifted

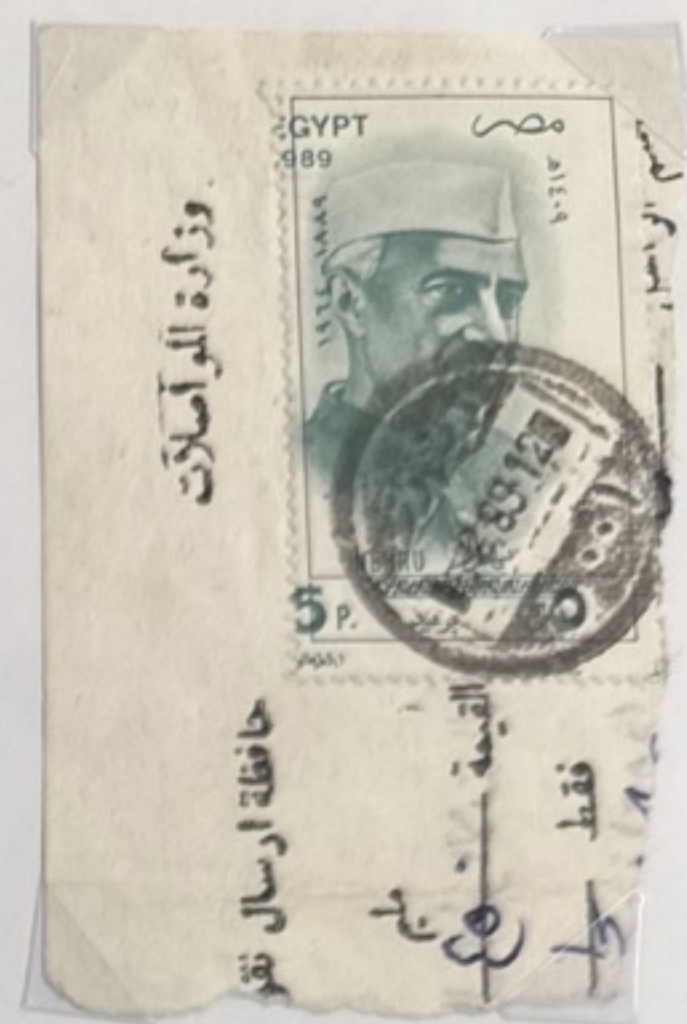

1988;5pi  
Misperforate  
on Fragment



1990;Set  
Misperforate  
on FDC



**1988;5pi  
Misperforate  
Lower  
Stamps**



**1993;15pi  
Unrecorded  
Misplaced  
Perforation**



**1993;15pi  
Unrecorded  
Misplaced  
Perforation**



**1996;15pi  
Double  
Print**

**1995;15pi  
Unrecorded  
Blue Blotch**



**1996;15pi  
Unrecorded  
Part of  
Design is  
Missing**



**1995;15pi  
Unrecorded  
Red Color  
Shifted**

دار العفتاء الجديدة

EGYPT

مصر

غلاف أول يوم  
FIRST DAY COVER

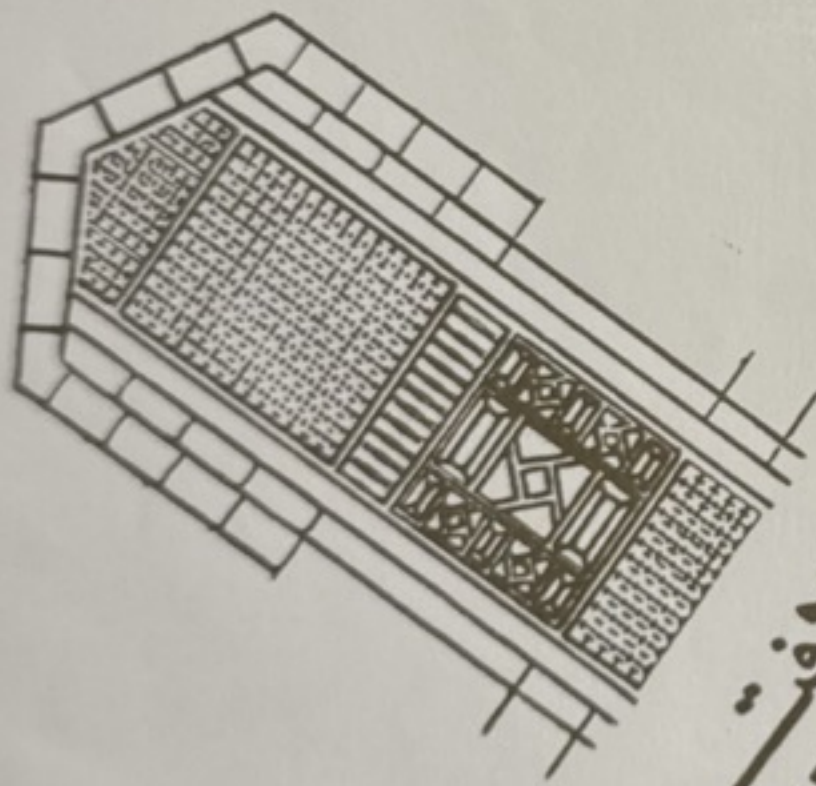

دار العفتاء  
DAR AL EFTAA OF EGYPT

1991; Opening of Dar El Eftaa's New Building proof of FDC.

مطابق مع ١٩٧٣

EGYPT

مصر

مطابق مع ١٩٧٣  
FIRST DAY COVER



مطابق مع الكتيب رقم ١٩٩١



GIZA-ZOO 1891  
مأوى الحيوانات - القاهرة ١٩٩١

EGYPT

FIRST DAY COVER  
غلاف اول يوم



The Printing House of Posts-Cairo

**1993;55pi**  
**Unrecorded**  
**Shifted**  
**Blue Color**

**1999;20pi**  
**Two Diff.**  
**Shades**



**1998;20pi**  
**Unrecorded**  
**Blue & Yellow**  
**Colors are**  
**Shifted**



**2002;30pi**  
**Unrecorded**  
**Misperforate**

عيد الشرطة  
الشرطة  
١٩٩٧



POLICE  
DAY  
1997

EGYPT

مصر



FIRST DAY COVER غلاف أول يوم

1997;20pi  
Unrecorded  
Part of  
Inscription  
Missing



2003;30pi  
Imperforate  
Block of 6





2002;125pi  
Misperforate



2002;30pi  
Unrecorded  
Misperforate

2002;Set  
Misperforate





**2002;30pi  
Unrecorded  
Matt Paper**



**2003;30pi  
Unrecorded  
Misperforate**

**2004;30pi  
Unrecorded  
Double  
Black Color**



**2003;125pi  
Unrecorded  
Imperforate  
Block of 6**



**2003;30pi  
Unrecorded  
Misperforate**



2004;30pi  
Unissued  
Stamp



2004;30pi  
Unrecorded  
Shifted  
Blue Color



2005;30pi  
Unrecorded  
Shifted  
Blue Color



2006;30pi  
Unrecorded  
Imperforate



2005;30pi  
Unrecorded  
Imperforate  
Two Shades



2007;150pi  
Unissued  
Stamp



2006;Set  
Unrecorded  
Shifted Red  
Color

2006;Set  
Unrecorded  
Imperforate



free 22 1/19/09 6:16 PM Page 1

2008;30pi  
Unrecorded  
Imperforate  
Block of 15



1951;S/S  
Wedding  
Unrecorded  
Perforation  
Shift  
to Right

تذكار القديسة الملكة السعيدة  
٣ رجب ١٣٧٠ - ٦ مايو ١٩٥١



1951;S/S  
Wedding  
Unrecorded  
Perforation  
Shift  
to Left

تذكار القديسة الملكة السعيدة  
٣ رجب ١٣٧٠ - ٦ مايو ١٩٥١



1951;S/S  
Wedding  
Unrecorded  
Green  
Blotches



1951;S/S  
Games  
Extra Dot  
in "1951"



**1958;S/S**  
**Flag**  
**Misplaced**



**1961;S/S**  
**Unrecorded**  
**Miscut**



**1964;S/S**  
**Unrecorded**  
**Black Blotch**



1969;S/S  
 Unrecorded  
 Miscut with  
 Normal



1971;S/S  
 Red Color  
 Misplaced



1979;S/S  
Unrecorded  
Miscut



1987;S/S  
Unrecorded  
Red Color  
Shifted FDC



1988;S/S  
Unrecorded  
Miscut



1988;S/S  
Unrecorded  
Double  
Print



1990;S/S  
Unrecorded  
Miscut  
on FDC



1991;S/S  
Unrecorded  
Light Red



1991;S/S  
Unrecorded  
Red Blotch



1996;S/S  
Unrecorded  
Dif. Shades



1997;S/S  
Unrecorded  
Blue Blotch



**1933;1m  
Black Dot  
on Plane  
Wing  
NP A3b**



**1929;27m  
Control  
Extra  
Island  
NP A2b**



**1933;2m  
Unrecorded  
White Dot  
before  
Value**



**1933;4m  
Broken  
1<sup>st</sup> "N"  
NP A7a**



**1933;7m  
"S" of "Mills"  
has Serif  
NP A10a**



**1933;1m  
Deformed  
2<sup>nd</sup> "E"  
NP A3c  
Shades**



**1933;5m  
Unrecorded  
White Dot  
before "5"  
Position 1**



**1933;5m  
Center  
Slightly  
Misplaced  
NP A8c**



1933;7m  
Unrecorded  
Center  
Slightly  
Misplaced



1933;8m  
Broken  
Lines  
Mint &  
Used



1933;9m  
Center  
Slightly  
Misplaced  
NP A12a



1933;20m  
White Line  
at Upper  
Left  
Value



1933;30m  
Unrecorded  
Accent  
over "E"



1933;20m  
Dot under  
Left  
Value



1933;30m  
Unrecorded  
Dot after  
"30"



1946;5m  
Inverted  
w/k



1946;5m  
Unrecorded  
Vertical  
Lines



1946;5m  
Unrecorded  
Dot under  
"p" of  
"Egypt"



1946;25m  
Cloud in  
the Sky  
NP A26e



1946;25m  
Unrecorded  
Vertical  
Lines



1946;25m  
Unrecorded  
Dot in front  
Of Plane



1946;30m  
Unrecorded  
Vertical  
Lines

1946;25m  
Unrecorded  
White Dots



1947;40m  
Unrecorded  
Vertical  
Lines



**1951;2m KES  
Distorted  
Characters  
NP A40a**



**1951;2m KES  
Broken  
"Malek"  
NP A40b**



**1951;2m KES  
Unrecorded  
Double o/p**



**1951;3m KES  
Unrecorded  
Inverted o/p**



**1951;7m KES  
Unrecorded  
Inverted o/p**



**1951;7m KES  
Broken  
"Malek"  
NP A43b**



**1951;7m KES  
Unrecorded  
Split "N"  
of Arabic**



**1951;8m KES  
Unrecorded  
Inverted o/p**



**1951;10m KES  
Broken  
Characters  
NP A45a**



**1951;8m KES  
Unrecorded  
Double o/p**



**1951;40m KES  
Broken  
"Malek"  
NP A48d**

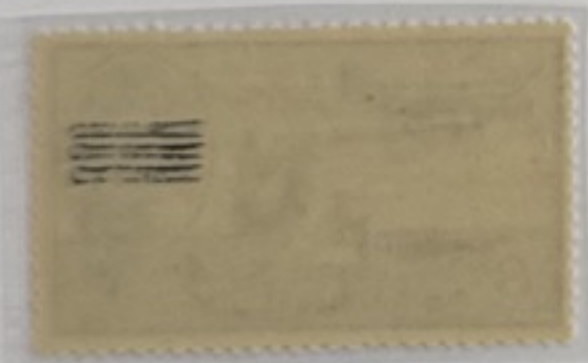

**1953;3m Bars  
Unrecorded  
Offset Bars**



**1953;5m Bars  
Unrecorded  
Offset Bars**



**1953;20m Bars  
Unrecorded  
Offset Bars**



**1953;7m Bars  
Unrecorded  
Double Bars  
One Misplaced**



**1953;30m Bars  
Unrecorded  
Misplaced  
Bars**



**1953;20m Bars  
Unrecorded  
Misplaced  
Bars**



**1953;2m KES Bars  
Unrecorded  
Broken  
Arabic "N"**



**1953;40m Bars  
Inverted w/k  
NP A62a**



**1953;2m KES Bars  
Distorted  
Characters  
NP A66b**



**1953;2m KES Bars  
Broken "M" of  
"Malek"  
Mint & Used  
NP A66a**



**1953;2m KES Bars  
Unrecorded  
Bars a Cheval**



**1953;2m KES Bars  
Unrecorded  
Black Line**



**1953;3m KES Bars  
Broken  
Characters  
NP A67a**



**1953;2m KES Bars  
Unrecorded  
Double Bars  
one Misplaced**



**1953;3m KES Bars  
Unrecorded  
Double KES**



**1953;5m KES Bars  
Unrecorded  
Double Bars  
one Misplaced**



**1953;3m KES Bars  
Unrecorded  
Double Bars  
one Misplaced**



**1953;5m KES Bars  
Broken  
Characters  
NP A68d**

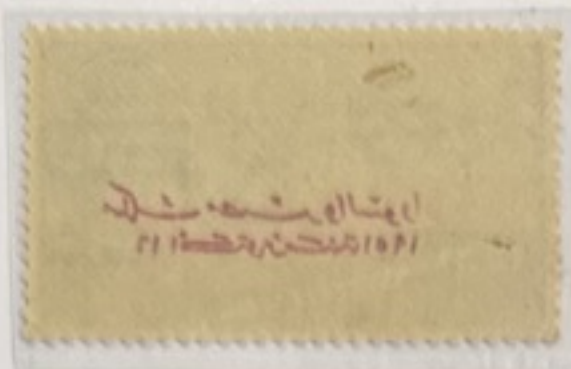

**1953;8m KES Bars  
Unrecorded  
Offset KES**



**1953;5m KES Bars  
Unrecorded  
Double KES**



**1953;10m KES Bars  
Distorted  
Characters  
NP A70b**



**1953;10m KES Bars  
Unrecorded  
Double Bars  
One Misplaced**



**1953;20m KES Bars  
Unrecorded  
Double KES**



**1953;10m KES Bars  
Double Bars**

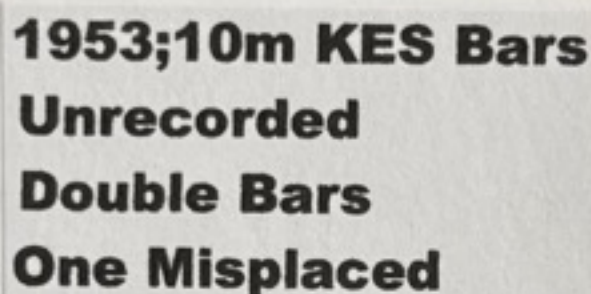

**1953;20m KES Bars  
Unrecorded  
Inverted KES**



**1953;40m KES Bars  
Unrecorded  
Double KES**



**1953;100m KES Bars  
Broken  
Characters  
NP A73a**



**1953;100m KES  
Unrecorded  
Double Bars  
One Misplaced**



**Bars 1953;15m  
Inverted  
Watermark  
NP A53a**



**1953;40m KES Bars  
Unrecorded  
Inverted KES**



**1963;20m  
UAR w/k  
NP A80c**



**1963;30m  
UAR w/k  
NP A81b**



**1963;40m  
UAR w/k  
NP A82b**



**1997;75pi  
Unrecorded  
Grey Color  
Shifted  
Upward**

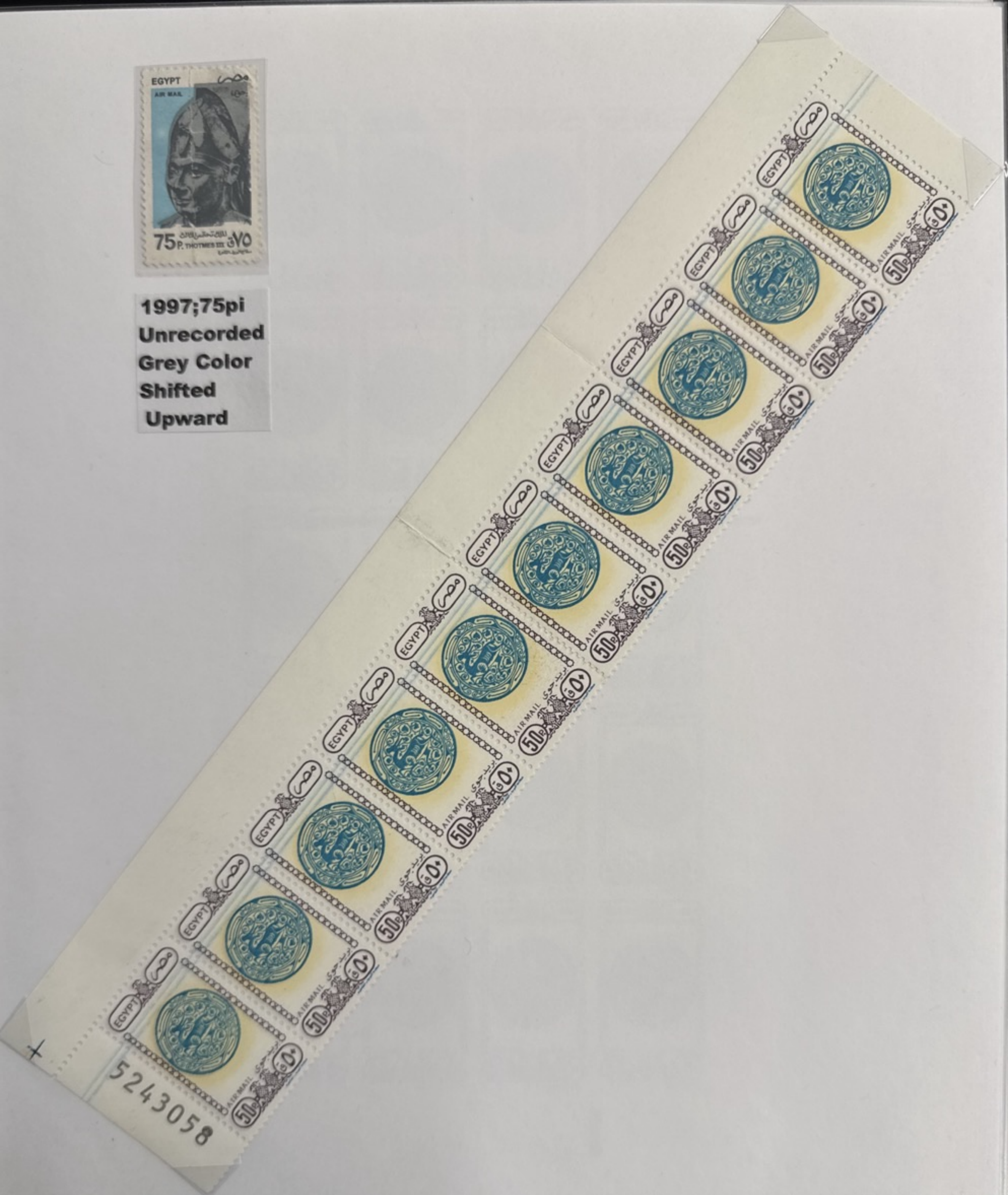

**1989-1991;50 pi Doctor's Blade 2 horizontal blue lines across the upper strip on 10 of sheet.  
Unrecorded.**



1989-1991; 50 pi Doctor's Blade 2 horizontal violet lines across a strip of 4 on 3<sup>rd</sup> row of sheet.  
Unrecorded.



**1989-1991;60 pi Doctor's Blade multiple blue horizontal lines across a strip of 5 on 2nd sheet row. Unrecorded.**



**1989-1991;60 pi Doctor's Blade multiple violet horizontal lines across a strip of 7 on lower sheet row. Unrecorded.**

Y  
2,3  
↓



← 3



← 3



C

M



1993;55pi Unrecorded two golden blotches on 2 stamps in a sheet of 35.



1993;55pi Unrecorded golden blotches on various stamps in a strip of 14.



1997-1998;1LE unrecorde prefolded paper variety on block of 20.



**10 para Grey  
Inverted w/k**



**1pi Rose  
Unrecorded  
Flaw on**



**1pi Rose  
Unrecorded  
Rose Red**



**20pa/5pi  
Hole in "0"**



**1pi Blue  
Inverted  
w/k  
Chalky**



**20pa/5pi  
Inverted  
o/p**



**10 para Green  
Blue Color  
Instead of  
Green**



**1pi Blue  
Inverted  
w/k  
Normal**



**20pa/5pi  
Misplaced  
o/p**



**2m Green  
Unrecorded  
w/k a Cheval**



**3m Orange  
Unrecorded  
Dot on Sphinx**



**1m Brown  
Inverted  
w/k**



**2m Green  
Inverted  
w/k**



**3m Orange  
Unrecorded  
w/k a Cheval**



5m 1914  
Inverted



5m 1914  
w/k to Right



5m 1914  
w/k to Left



2m/3m 1915  
Unrecorded  
Broken "M"



2m/3m 1915  
Broken "E"



2m/3m 1915  
Unrecorded  
Broken Alef



5m 1921  
Booklet  
Stamp



1m Crown T1  
Missing dots  
& Broken  
Frame



1m Crown T2  
Missing Dots  
& Broken  
Frame



2m Crown T1  
Inverted w/k



100m Crown  
Inverted w/k



**5m 1st Portrait**  
**Imperforate**  
**Pair**



**50m/50pi**  
**Irregular**  
**Perforation**



**5m 1st Portrait**  
**Unrecorded**  
**Retouch**



**15m 2nd Portrait**  
**Booklet Stamp**



**1LE 2nd Portrait**  
**Closed "U"**



**20m 2nd Portrait**  
**Unrecorded**  
**Mirror Image**



**5m Postes**  
**Booklet**  
**Stamp**



**1m Boy King  
Unrecorded  
Prefolded  
Paper**



**1m Boy King  
Inverted w/k  
Group**



**1m Boy King  
Unrecorded  
Line Across  
"1" Upper  
Left Stamp**



**2m Boy King  
Unrecorded  
Slash Color**



**3m Boy King  
Unrecorded  
Blotches**



**3m Boy King  
Unrecorded  
Dot Under  
Eye of King**



**3m Boy king  
Inverted w/k  
Group**





**3m Boy King  
Inverted w/k  
Group**



**4m Boy King  
Inverted w/k  
Used**



**4m Boy King  
Unrecorded  
Horizontal  
Lines**



**3m Boy King  
Unrecorded  
Horizontal  
Lines**



**5m Boy King  
Inverted w/k  
Group**





**5m Boy King  
Unrecorded  
Horizontal  
Lines**



**6m Boy King  
Inverted w/k  
Group**

**5m Boy King  
Inverted w/k  
Group**





**10m Boy King  
Unrecorded  
Screening  
Error**



**10m Boy King  
Inverted w/k  
Group**



**13m Boy King  
Unrecorded  
Horizontal  
Lines**



**15m Boy King  
Inverted w/k  
Group**





**15m Boy King  
Inverted w/k**



**20m Boy King  
Unrecorded  
Printing Error**



**20m Boy King  
Inverted w/k  
Group**



**20m Boy King  
Unrecorded  
White Blotches**



**15m Boy King  
Inverted w/k  
Block Controls**



**30m Boy King  
Broken "3"**



30m Boy King  
Stroke on "3"



30m Boy King  
Stroke on "3"



30m Boy King  
Broken "3" &  
Stroke on "3"



30m Boy King  
Stroke on "3"



30m Boy King  
Broken "3"



40m Boy King  
Inverted w/k



**1m Marechal  
Misperforate**



**1m Marechal  
Unrecorded  
Broken Frame**



**1m Marechal  
Inverted w/k**



**2m Marechal  
Unrecorded  
Shifted  
Perforation**



**4m Marechal  
Unrecorded  
Shifted  
Perforation**



**4m Marechal  
Unrecorded  
Horizontal  
Lines**



**4m Marechal  
Deformed  
Arabic**





**5m Marechal  
Unrecorded  
Color  
Changing**



**5m Marechal  
Unrecorded  
Horizontal  
Lines**



**5m Marechal  
Unrecorded  
Printing  
Blotch**



**10m Marechal  
Unrecorded  
White Dot  
On Fez**



**10m Marechal  
Unrecorded  
White Dot  
On Face**



**17m Marechal  
Accent on  
Arabic**



**22m Marechal  
Unrecorded  
Blue Blotch**



**30m Marechal  
Unrecorded  
Double  
Impression**



**30m Marechal  
Unrecorded  
Dot Under  
Eye**



**1LE Marechal  
Unrecorded  
Missing  
Perforation**



**1m KES  
Unrecorded  
Misprint**



**1m KES  
Unrecorded  
Blotches**

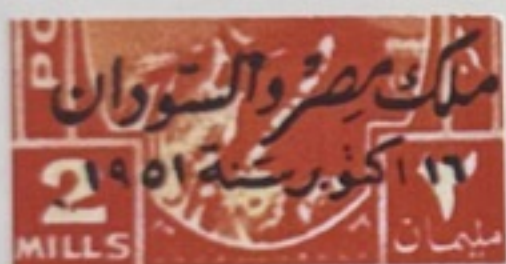
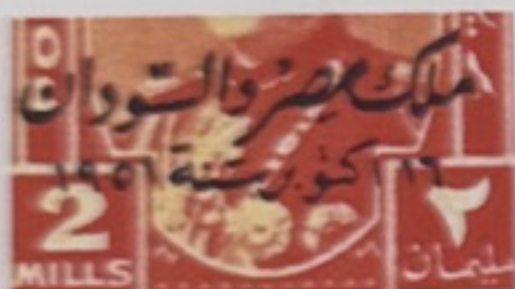

**4m KES  
Unrecorded  
Green  
Blotch**

**2m KES  
Unrecorded  
Blotches**

**4m KES  
Unrecorded  
Blotches**



**10m KES  
Unrecorded  
Blotches**



**10m KES  
Damaged  
Arabic "N"**

**10m KES  
Damaged  
Arabic "K"**





**3m Civil  
3 Bars  
Unrecorded  
Horizontal  
Lines**



**1m Marechal  
3 Bars  
Unrecorded  
Bars a Cheval**



**2m Marechal  
3 Bars  
Unrecorded  
Split Bars**



**2m Marechal  
3 Bars  
Unrecorded  
Shifted Bars**



**6m Civil  
3 Bars  
Unrecorded  
Prefolded  
Paper**



**3m Marechal  
3 Bars  
Inverted Bars**



**10m Marechal  
3 Bars  
Unrecorded  
Shifted Bars**



**10 Marechal  
3 Bars  
Unrecorded  
Shifted Bars**



**10m Marechal  
3 Bars  
Unrecorded  
Split Bar**



**10m Marechal  
3 Bars  
Unrecorded  
Faint Bars**



**15m Marechal  
3 Bars  
Unrecorded  
Bars a Cheval**



**15m Marechal  
3 Bars  
Unrecorded  
Bars a Cheval**



**1m KES 3 Bars  
Unrecorded  
Inverted  
Overprint**



**1m KES 3 Bars  
Unrecorded  
Double o/p**



**2m KES 3 Bars  
Broken Arabic  
"N"**



**2m KES 3 Bars  
"66" Instead  
Of "16"**



**13m KES 3 Bars  
Unrecorded  
Blotches**



**1m Farouk  
Civil 6 Bars**



**3m Marechal  
6 Bars  
Unrecorded  
Shifted Bars**



**6m Farouk  
Civil 6 Bars**



**6m Farouk  
Civil 6 Bars  
Shifted Bars**



**2m Marechal  
6 Bars  
Unrecorded  
Shifted Bars**



**10m Marechal  
6 Bars  
Unrecorded  
Shifted Bars**



2m Farmer  
Unrecorded  
Mirror  
Image



3m Farmer  
Unrecorded  
Mirror  
Image



4m Farmer  
Unrecorded  
Mirror  
Image



10m Soldier  
Unrecorded  
Blurred  
Printing



10m Soldier  
Unrecorded  
Misprint  
"Egypte"



15m Soldier  
Unrecorded  
Mirror  
Image



17m Soldier  
Imperforate  
w/Remarks



30m Mosque  
Unrecorded  
Prefolded  
Paper



1957; 10m Soldier pair & 40m mosque all with shifted perforation and others tied by "Isna" cds on part of domestic parcel card.



30m Mosque  
Inverted w/k



30m Mosque  
Unrecorded  
Blurred  
Printing



32m Mosque  
Imperforate  
w/Remarks



35m Mosque  
Unrecorded  
Prefolded  
Paper



35m Mosque  
Unrecorded  
Blurred  
Printing



40m Mosque  
Unrecorded  
Vert.Lines



50m Mosque  
unrecorded  
Prefolded  
Paper



55m/100m  
UAP  
Instead  
Of UAR



55m/100m  
Unrecoded  
Shifted to  
Right



55m/100m  
Unrecoded  
Shifted to  
Down



55m/100m  
Unrecoded  
Shifted to  
Left



5m Factory  
Inverted w/k



1m Farmer  
Inverted w/k



10m Ramses  
Inverted w/k



1m Farmer  
Inverted w/k



2m Mosque  
Inverted w/k



**4m Lamp  
Color Dot  
at Right  
of "4"**



**3m Nefertiti  
Inverted w/k**



**10m Ramses  
Misperforate**



**5m Factory  
Unrecorded  
Vert.Lines**



**35m Defin.  
Unrecorded  
Misprint.**



**10m Ramses  
Misperforate**



**10m Ramses  
Imperforate**



20m Defin.  
Unrecorded  
Blotches



40m Defin.  
Inverted w/k



20m Defin.  
Unrecorded  
Misprint



45m Defin.  
Imperforate



500m Nefertiti  
Red Color  
Badly  
Misplaced



4m Defin.  
Misperforate



1961; 100m Definitive with variety; black color misplaced used with others on registered airmail advertising cover sent to England.



1m Farmer  
Unrecorded  
Misperforate

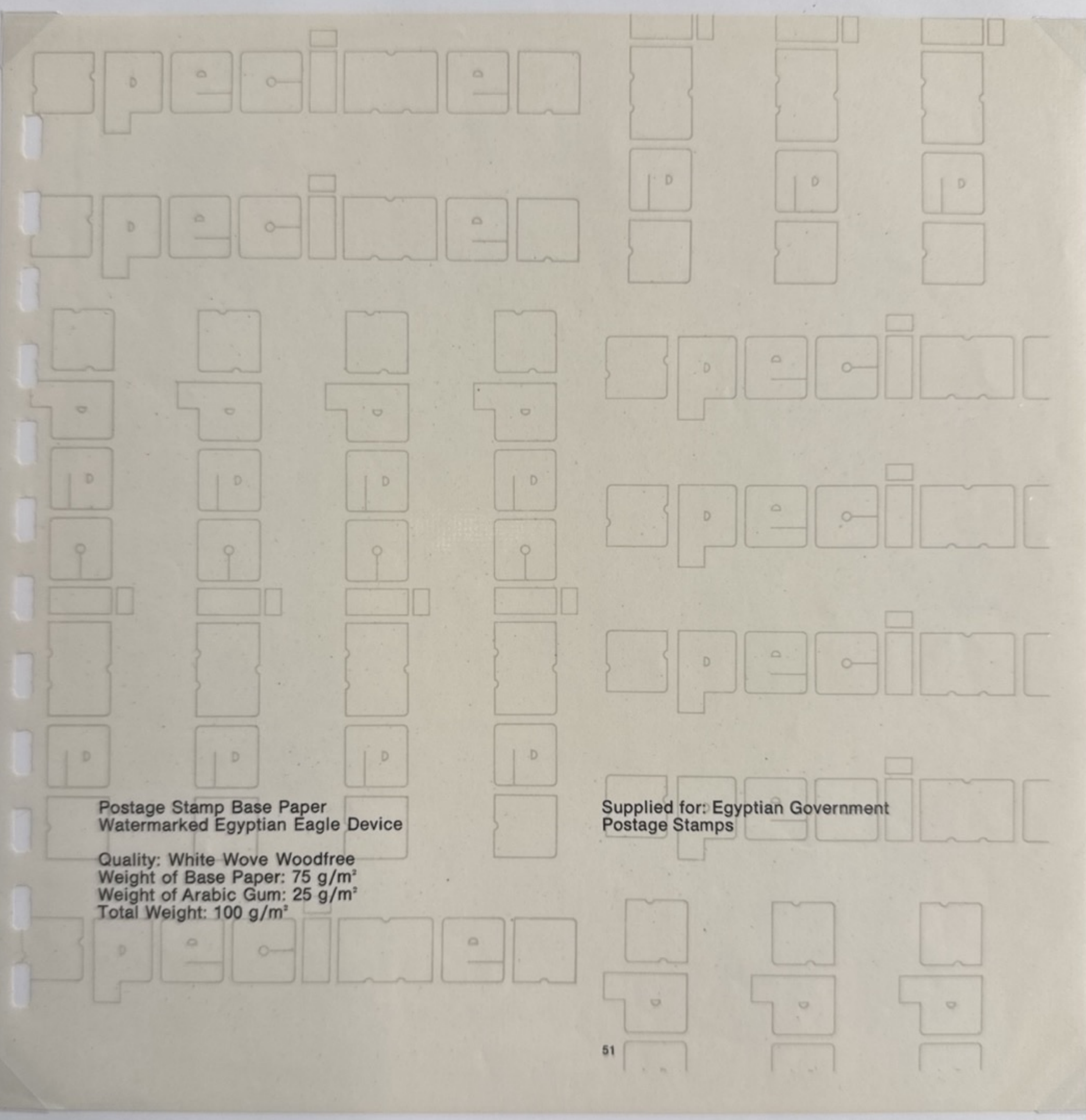

Postage Stamp Base Paper  
Watermarked Egyptian Eagle Device

Quality: White Wove Woodfree  
Weight of Base Paper: 75 g/m<sup>2</sup>  
Weight of Arabic Gum: 25 g/m<sup>2</sup>  
Total Weight: 100 g/m<sup>2</sup>

Supplied for: Egyptian Government  
Postage Stamps

Sample of paper used in printing of stamps bearing the "Eagle" watermark.



200m Defin.  
Unrecorded  
Misprint



10m Defin.  
Unrecorded  
Misperforate



1LE Defin.  
Unrecorded.  
Green Color  
Misplaced



10pi Defin.  
Misperforate



10pi Defin.  
Misperforate



5pi Defin.  
Misperforate



5pi Defin.  
Unrecorded  
Double  
Black



5pi Defin.  
Unrecorded  
Double  
Printed

231569

A (1)

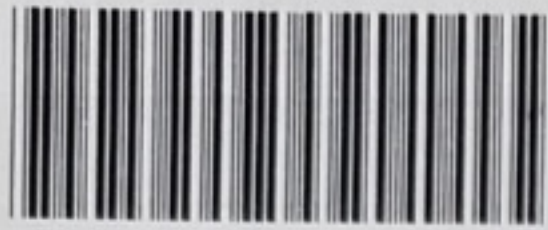

Handwritten signature

أنوميفير الثالث

Unique Essay of a definitive stamp statue with a denomination of 15pi signed by designer.



20m Defin.  
Misperforate



2LE Defin.  
Unrecorded  
Misprint

15pi Defin.  
Unrecorded  
Yellow Color  
Misplaced



1LE Nefertiti  
Unrecorded  
Misperforate



10pi Defin.  
Imperforate  
Greenish  
Color



10pi Defin.  
Imperforate  
Regular  
Color



110m Defin.  
Unrecorded  
Diff.Colors



150pi Defin.  
Unrecorded  
Red Color  
Misplaced



**125Pi Defin.  
Unrecorded  
Misprint**

**1LE Defin.  
Unrecorded  
Misprint**

